

# JORDAN BAY MARINA - FUEL TANK REPLACEMENT

1328 ROOSEVELT TRAIL  
RAYMOND, MAINE

**APPLICANT:**

**PORT HARBOR MARINE**

1 SPRING POINT DRIVE  
SOUTH PORTLAND, ME 04106

**ENGINEER/SURVEYOR/  
LANDSCAPE ARCHITECT:**

**SEBAGO  
TECHNICS**

WWW.SEAGOTECHNICS.COM

75 John Roberts Rd.  
Suite 4A  
South Portland, ME 04106  
Tel. 207-200-2100

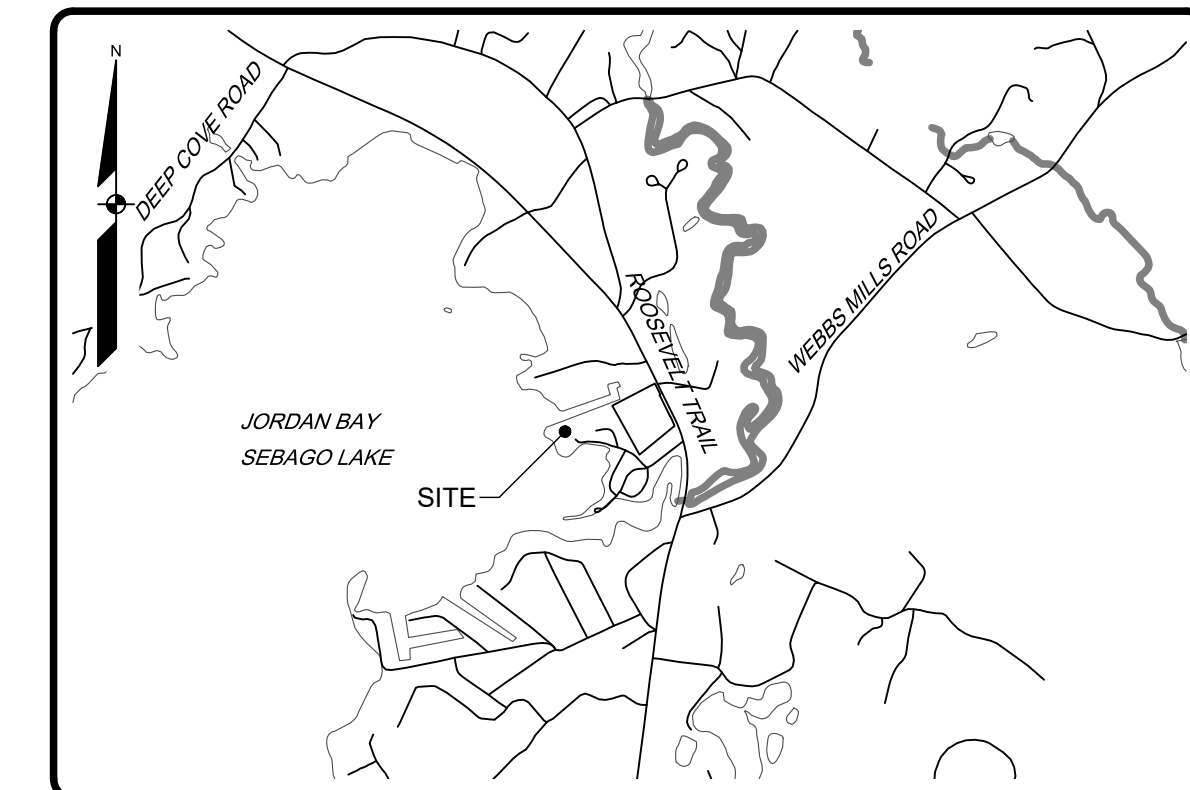
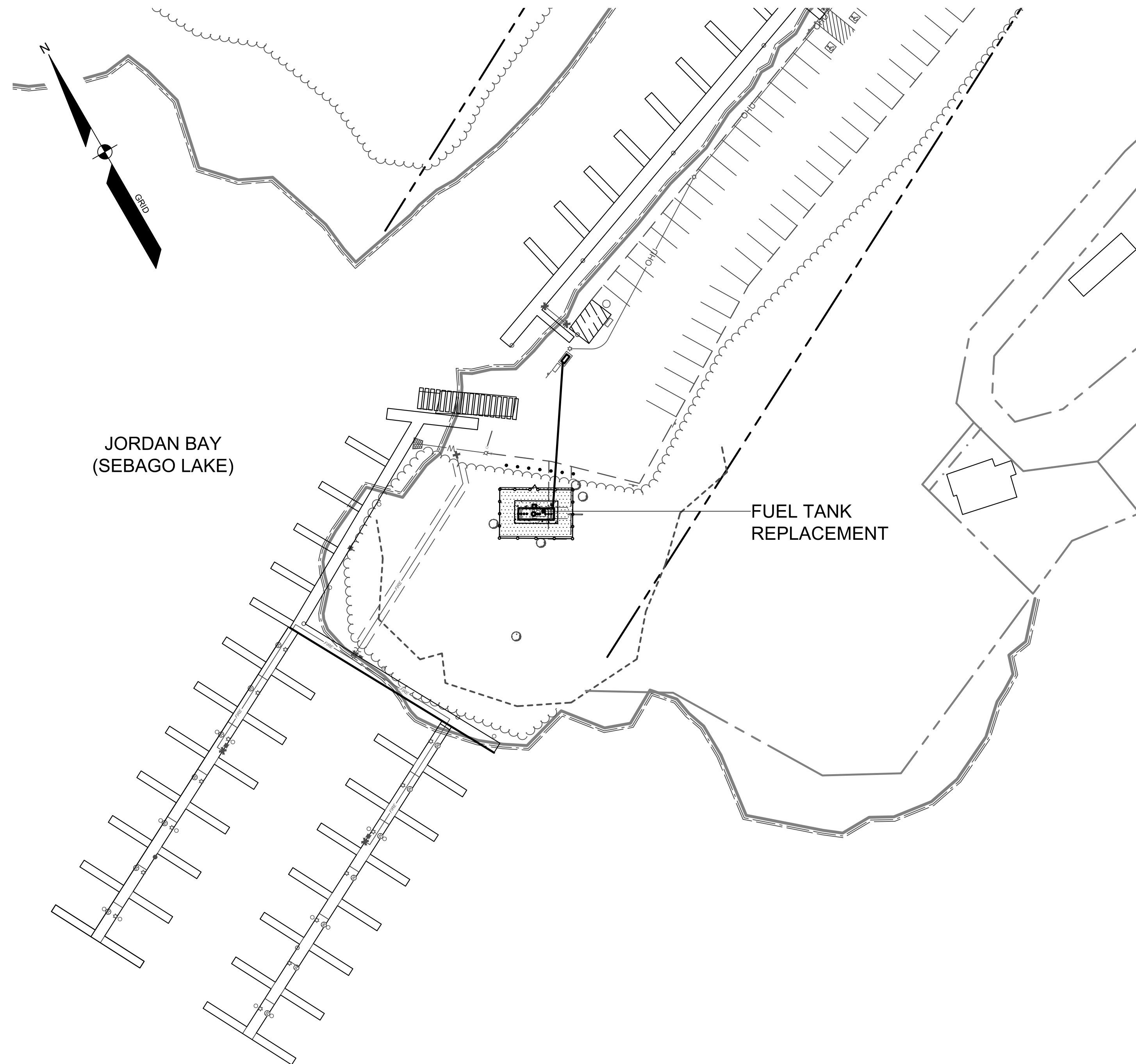

LOCATION MAP

NTS

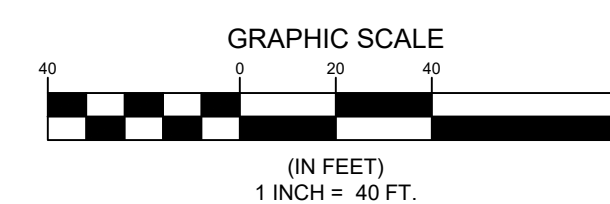

**Sheet List Table**

Sheet Number	Sheet Title
1	COVER SHEET
2	SITE PLAN
3	EROSION CONTROL NOTES
4	DETAILS

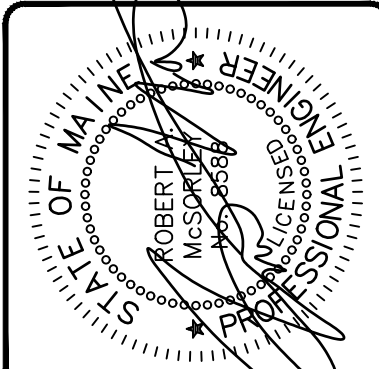

REV	BY	DATE	STATUS
A	RAM	08/01/22	SUBMISSIONS TO TOWN & MDEP

THIS PLAN SHALL NOT BE MODIFIED WITHOUT WRITTEN PERMISSION FROM SEBAGOTECHNICS, INC. ANY ALTERATIONS, AUTHORIZED OR OTHERWISE, SHALL BE AT THE USER'S SOLE RISK AND WITHOUT LIABILITY TO SEBAGO TECHNICS, INC.

**SEBAGO  
TECHNICS**  
WWW.SEAGOTECHNICS.COM  
75 John Roberts Rd.  
Suite 4A  
South Portland, ME 04106  
Tel. 207-200-2100

COVER SHEET  
OF:  
JORDAN BAY MARINA - FUEL TANK REPLACEMENT  
1328 ROOSEVELT TRAIL  
RAYMOND, MAINE  
FOR:  
PORT HARBOR MARINE  
1328 ROOSEVELT TRAIL  
SOUTH PORTLAND, ME 04106

DESIGNED	RAM
DRAWN	DAB
CHECKED	RAM
DATE	07/22/22
SCALE	1" = 40'
PROJECT	14265-03

14265-03 C-04a.dwg, TAB: 1 COVER SHEET





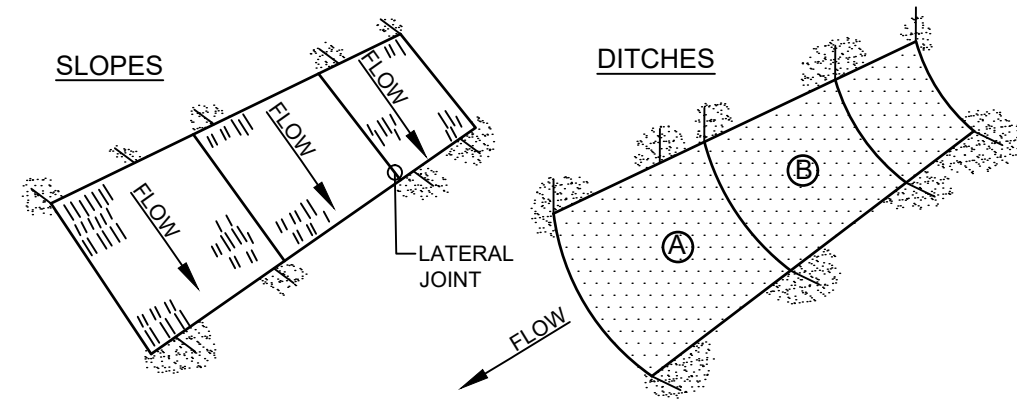

- NOTES:**
- BURY THE TOP END OF THE MESH MATERIAL IN A 6" TRENCH AND BACKFILL AND TAMP TRENCHING SECURE END WITH STAPLES AT 6" SPACING, 4" DOWN FROM EXPOSED END.
  - FLOW DIRECTION JOINTS TO HAVE UPPER END OF LOWER STRIP BURIED WITH UPPER LAYERS OVERLAPPED 4" AND STAPLED. OVERLAP B OVER A.
  - LATERAL JOINTS TO HAVE 4" OVERLAP OF STRIPS. STAPLE 18" ON CENTER.
  - STAPLE OUTSIDE LATERAL EDGE 2" ON CENTER.
  - WIRE STAPLES TO BE MIN OF #11 WIRE 6" LONG AND 1-1/2" WIDE.
  - USE NORTH AMERICAN GREEN DS 150 OR APPROVED EQUAL.

**EROSION CONTROL BLANKET**

NOT TO SCALE

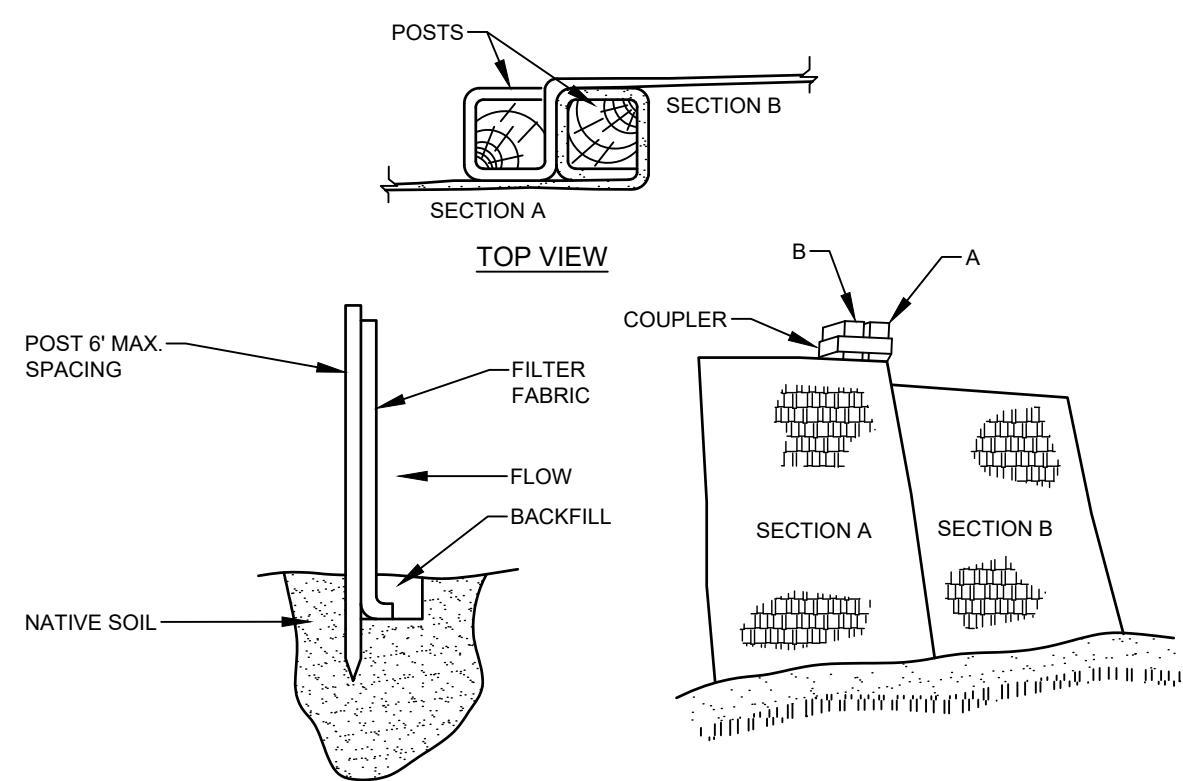

- INSTALLATION:**
- EXCAVATE A 6"x 6" TRENCH ALONG THE LINE OF PLACEMENT FOR THE FILTER BARRIER.
  - UNROLL A SECTION AT A TIME AND POSITION THE POSTS AGAINST THE BACK (DOWNSTREAM) WALL OF THE TRENCH.
  - DRIVE POSTS INTO THE GROUND UNTIL APPROXIMATELY 2" OF FABRIC IS LYING ON THE TRENCH BOTTOM.
  - LAY THE TOE-IN FLAP OF FABRIC ONTO THE UNDISTURBED BOTTOM OF THE TRENCH. BACKFILL THE TRENCH AND TAMP THE SOIL. TOE-IN CAN ALSO BE ACCOMPLISHED BY LAYING THE FABRIC FLAP ON UNDISTURBED GROUND AND PILING AND TAMPING FILL AT THE BASE, BUT MUST BE ACCOMPANIED BY AN INTERCEPTION DITCH.
  - JOIN SECTION AS SHOWN ABOVE.
  - BARRIER SHALL BE MIRAFI SILT FENCE OR EQUAL.
  - THE FENCE SHOULD BE ANCHORED TO RESIST PULL-OUT AND BE STRETCHED TIGHTLY BETWEEN STAKES TO PREVENT SAGGING.
  - IN AREAS WHERE FLAP CANNOT BE KEYED PROPERLY (DUE TO FROZEN GROUND, BEDROCK, STONY SOILS, ROOTS NEAR A PROTECTED NATURAL RESOURCE, ETC.) THE SILT FENCE SHOULD BE ANCHORED WITH AGGREGATE, CRUSHED STONE, EROSION CONTROL MIX OR OTHER MATERIAL.
  - FILTER BARRIER NEEDS TO BE REMOVED WHEN THE AREA IS STABILIZED.

**FILTER BARRIER**

NOT TO SCALE

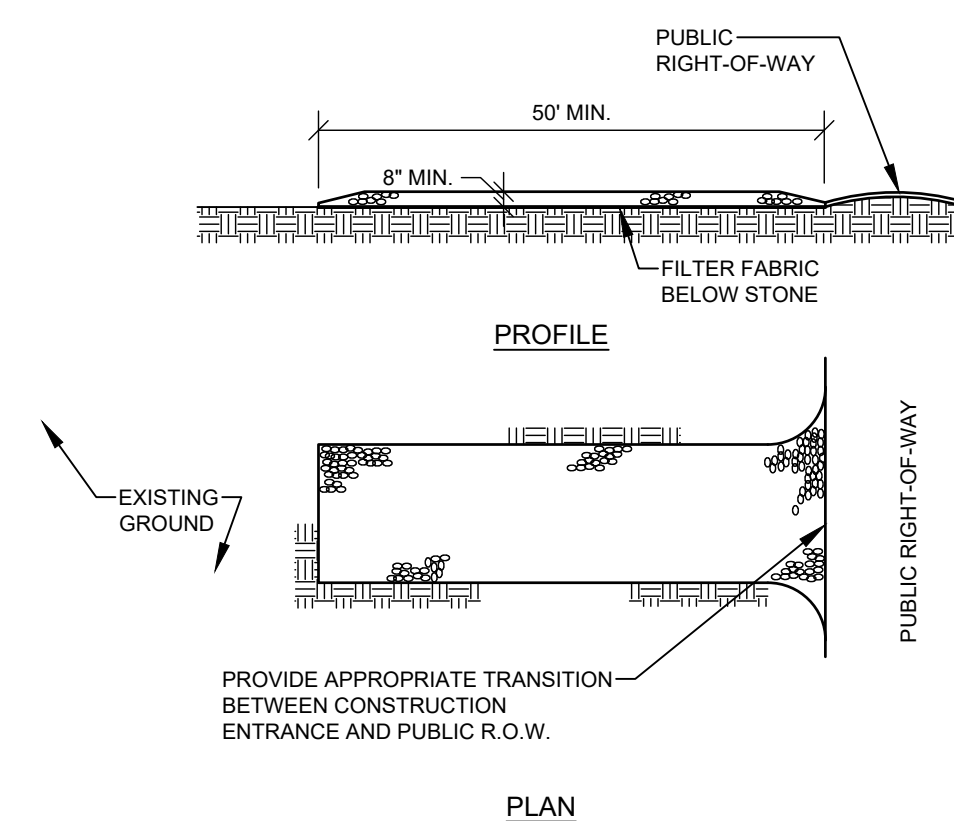

- NOTES:**
- STONE SIZE - AASHTO DESIGNATION M43, SIZE NO. 2 (2 1/2" TO 1 1/2"). USE CRUSHED STONE.
  - LENGTH - AS SHOWN ON PLANS, MIN. 50 FEET.
  - THICKNESS - NOT LESS THAN EIGHT (8) INCHES.
  - WIDTH - NOT LESS THAN FULL WIDTH OF ALL POINT OF INGRESS OR EGRESS.
  - MAINTENANCE - THE ENTRANCE SHALL BE MAINTAINED IN A CONDITION WHICH WILL PREVENT TRACKING OR FLOWING OF SEDIMENT ONTO PUBLIC RIGHT-OF-WAY. THIS MAY REQUIRE PERIODIC TOP DRESSING WITH ADDITIONAL STONE AS CONDITIONS DEMAND AND REPAIR AND/OR CLEANOUT OF ANY MEASURES USED TO TRAP SEDIMENT. ALL SEDIMENT SPILLED, DROPPED, WASHED OR TRACKED ONTO PUBLIC RIGHT-OF-WAY MUST BE REMOVED IMMEDIATELY.

**STABILIZED CONSTRUCTION ENTRANCE**

NOT TO SCALE

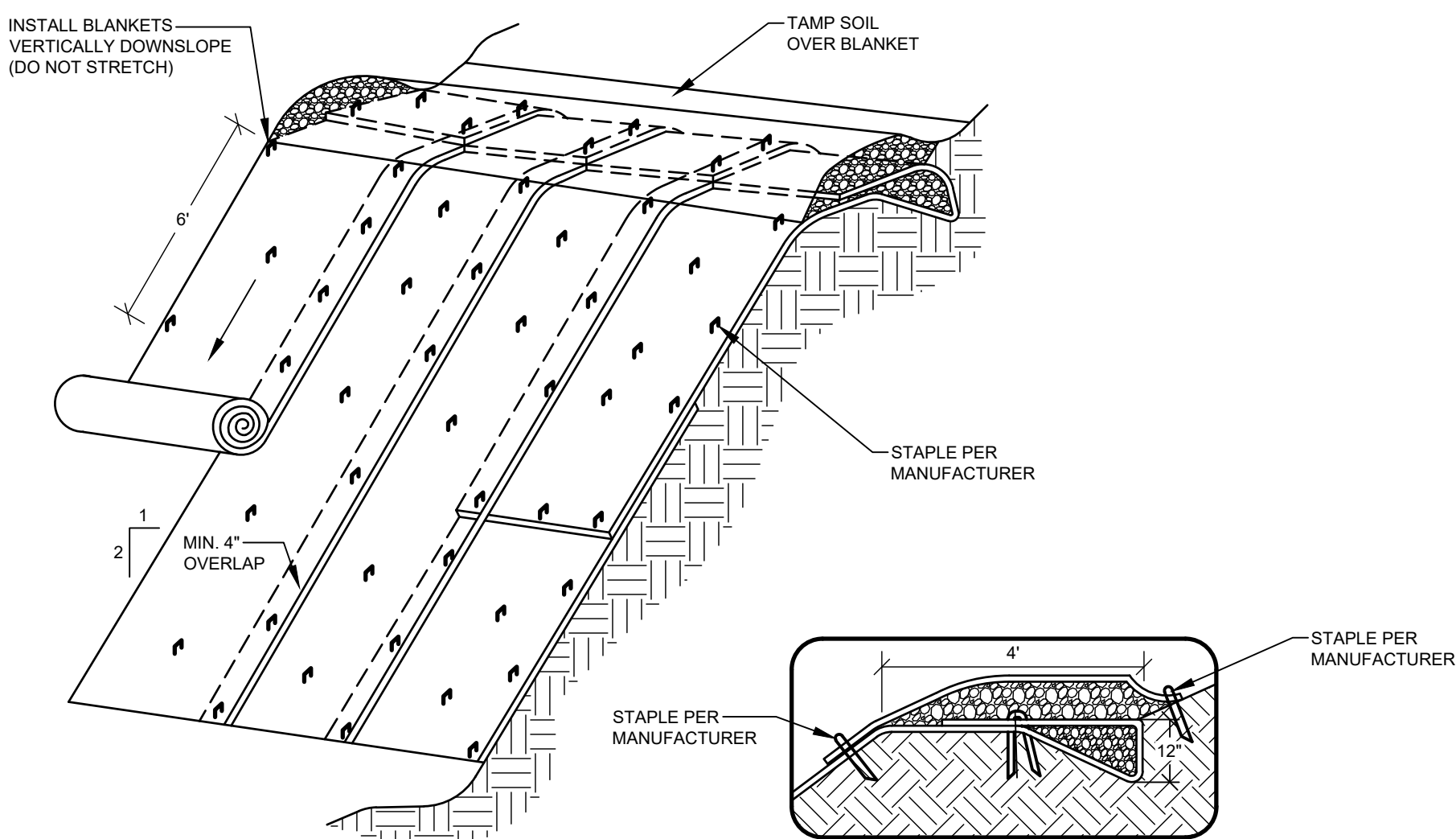

- CONSTRUCTION SPECIFICATIONS**
- THE SOIL SURFACE SHALL BE FINELY GRADED AND SMOOTH FOR THE BLANKET TO HAVE DIRECT CONTACT WITH THE SOIL AND TO PREVENT UNDERMINING.
  - SEED SHALL BE SOWN BEFORE INSTALLING THE EROSION CONTROL BLANKET.
  - ALWAYS UNROLL THE BLANKET DOWNHILL WITHOUT STRETCHING AND ANCHOR THE UPSLOPE EDGE IN A 12 INCH DEEP TRENCH THAT IS BACKFILLED AND TAMPED. COVER THE TAMPED SOIL WITH BLANKET AND STAPLE TO SECURE.
  - OVERLAP SHINGLE STYLE A MINIMUM OF 12 INCHES AT THE TOP OF EACH ROW AND 4 INCHES AT THE EDGES OF PARALLEL ROWS. ANCHOR ALONG THE OVERLAP WITH A MAXIMUM SPACING OF 3 FEET OR AS REQUIRED BY THE MANUFACTURER.

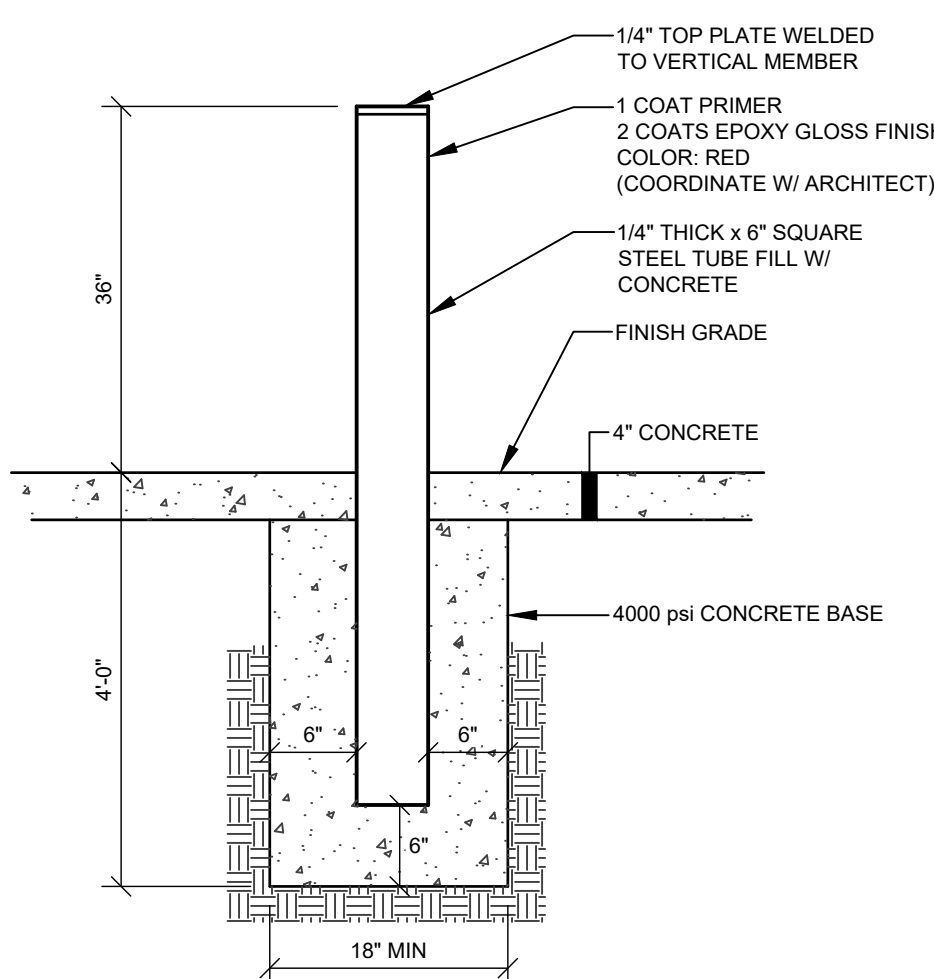

**METAL TOP PLATE BOLLARD**

NOT TO SCALE

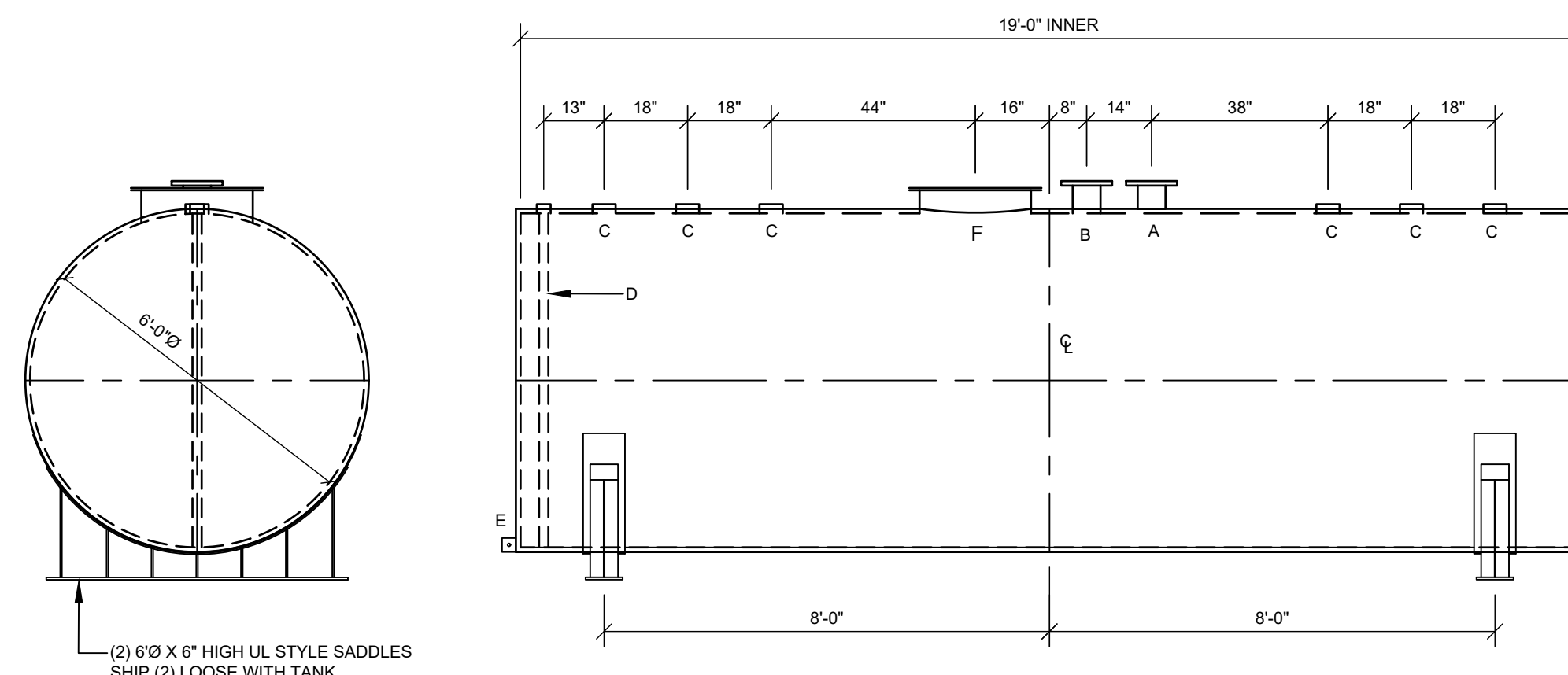

- DESIGN DATA:**
- CAPACITY: 4,000 GALLONS
  - TYPE: DOUBLE WALL - TYPE I
  - OPERATING PRESSURE: ATMOSPHERIC
  - SPECIFIC GRAVITY: 1.0
  - TANK MATERIAL: MILD CARBON STEEL
  - THICKNESS - INNER - HEADS: 1/4" SHELL: 1/4"
  - THICKNESS - OUTER - HEADS: 10 GA. SHELL: 10 GA

LEGEND	
A	6" FFSO 150# FLANGE THROUGH OUTER SHELL ONLY. MARK WITH SPECIAL WARNING LABEL INTERSTITIAL EMERGENCY VENT USE ONLY
B	6" FFSO 150# FLANGE - PRIMARY EMERGENCY VENT
C	4" FITTING
D	2" INTERNAL INTERSTITIAL MONITOR PIPE
E	3" x 3" PLATE W/ 1/2" (MIN.) HOLE ON $\epsilon$ (GROUNDING LUG - ONE REQ'D)
F	24" TIGHT BOLT MANWAY w/ 1/8" FIBREFLEX GASKET MATERIAL

**FUEL TANK (4,000 GAL)**

NOT TO SCALE

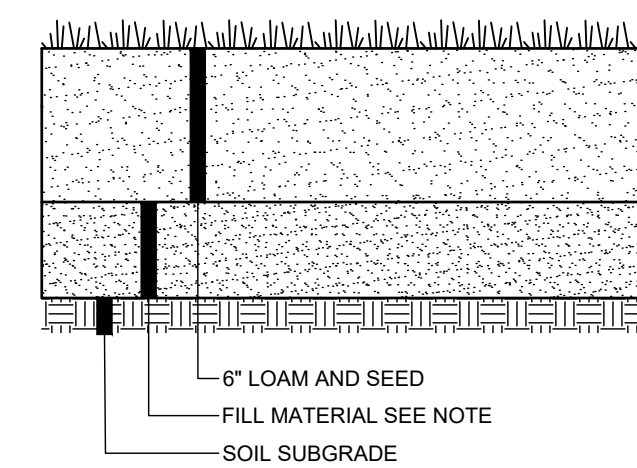

- NOTE:**
- FILL USED TO RAISE GRADE OVER SOIL SUBGRADES SHALL BE COMMON BORROW (MDOT 703.19)
  - FILL SHALL BE GRANULAR BORROW IN AREAS INDICATED IN GEOTECHNICAL REPORT

**LOAM & SEED (SOIL SUBGRADE)**

NOT TO SCALE

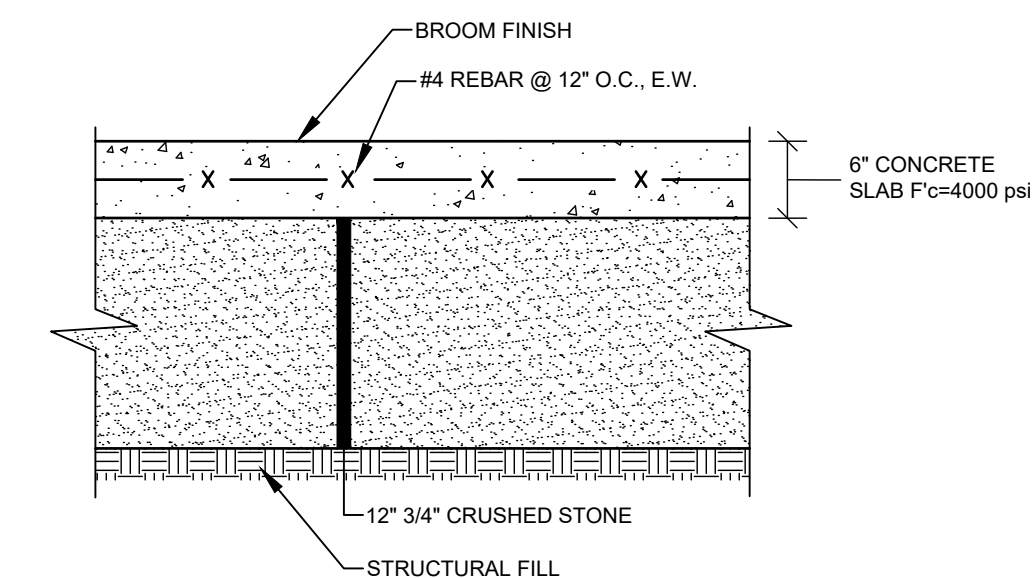

**CONCRETE SLAB**

NOT TO SCALE

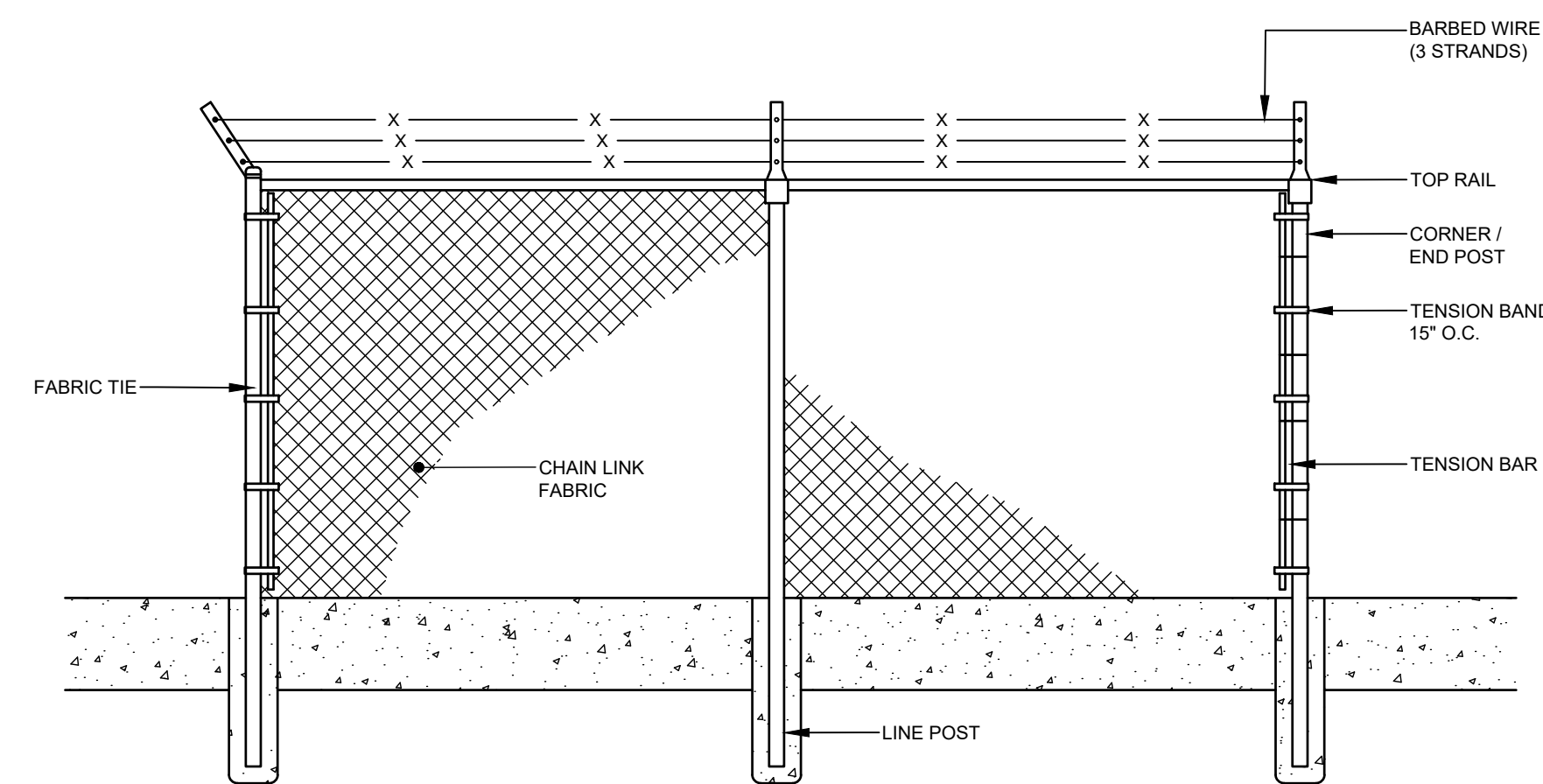

**CHAIN LINK FENCE WITH BARBED WIRE**

NOT TO SCALE

ROBERT A. MCSORLEY, P.E. 6588

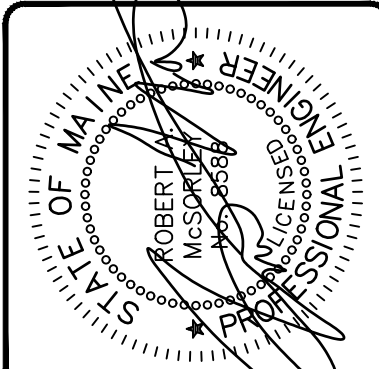

REV.	BY	DATE	STATUS	DESCRIPTION
A	RAM	08/01/22	SUBMISSIONS TO TOWN & MDEP	

THIS PLAN SHALL NOT BE MODIFIED WITHOUT WRITTEN PERMISSION FROM SEBAGOTECHNICS, INC. ANY ALTERATIONS, AUTHORIZED OR OTHERWISE, SHALL BE AT THE USER'S SOLE RISK AND WITHOUT LIABILITY TO SEBAGO TECHNICS, INC.

**SEBAGO**  
TECHNICS  
75 John Roberts Rd.  
Sullivan, ME 04106  
South Portland, ME 04106  
Tel. 207-200-2100  
WWW.SEAGOTECHNICS.COM

**DETAILS**  
OF  
**JORDAN BAY MARINA - FUEL TANK REPLACEMENT**  
RAYMOND, MAINE  
FOR:  
**PORT HARBOR MARINE**  
1 SPRING POINT DRIVE  
SOUTH PORTLAND, ME 04106

DESIGNED	RAM
DRAWN	DAB
CHECKED	RAM
DATE	07/22/22
SCALE	NTS
PROJECT	14265-03