

LOCATION MAP: USGS QUADRANGLE: RAYMOND
 MAPTECH® USGS TOPOGRAPHIC SERIES™
 ©MAPTECH®, INC. 978-933-3000
 WWW.MAPTECH.COM/TOPO

LEGEND:

DESCRIPTION	EXISTING	PROPOSED
PROPERTY LINE	---	---
BENCHMARK	⊕	
SURVEY STATION	⊕	
MANHOLE	⊕	⊕
UTILITY POLE	⊕	⊕
WELL	⊕	⊕
WATER VALVE	⊕	⊕
SIGN	⊕	⊕
CATCH BASIN	⊕	⊕
HYDRANT	⊕	⊕
EDGE OF GRAVEL	---	---
EDGE OF PAVEMENT	---	---
MAJOR FOOT CONTOUR	--- 100 ---	--- 100 ---
MINOR FOOT CONTOUR	--- 98 ---	--- 98 ---
STORM DRAIN	SD	SD
OVERHEAD UTILITIES	OHU	OHU
SILT FENCE	SF	SF
TREE LINE	⌋	⌋
GRAVEL SURFACE	⌋	⌋

PARCEL INFORMATION

MAP / LOT:	MAP 15, LOT 81A
LOT AREA (ACRES):	3
ZONE OR DISTRICT:	RURAL
EXISTING USE:	VACANT
FLOOD ZONE:	N/A
WATER:	WELL
SEWER:	SEPTIC FIELD
RECORD OWNER:	GARY A GILLIS

SITE DEVELOPMENT DATA

	SF	AC
NEW PAVEMENT	6593	0.15
TOTAL IMPERVIOUS:	6593	0.15
TOTAL DEVELOPED:	18201	0.42

DESIGN STANDARDS

	REQ'D	PROVIDED
MINIMUM ROAD FRONTAGE (FT)	225	75
MINIMUM SETBACK, FRONT YARD (FT)	40	N/A
MINIMUM SETBACK, OTHER YARDS (FT)	20	N/A
MINIMUM LOT AREA (ACRES)	3	3%
MAXIMUM BUILDING HEIGHT	2.5 STORIES	N/A

PROJECT INFORMATION

APPLICANT:	COMPANY NAME
	ATTN:
	ADDRESS
	CITY, STATE, ZIP
ENGINEER:	HALEY WARD
	ATTN: JON WHITTEN, JR., PE.
	120 MAIN STREET
	SUITE 132
	SACO, MAINE, 04072

- PLAN REFERENCE:**
- AERIAL TOPOGRAPHY PROVIDED BY NOAA.
 - PROPERTY LINES PROVIDED BY GPCOG ARCGIS MAPPING SERVICE.
 - EXISTING CONDITIONS DRAFTED USING AERIAL IMAGERY PROVIDED BY MICROSOFT BING.

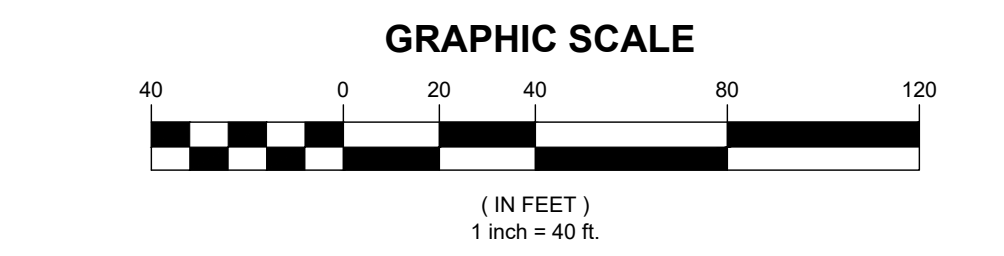

REV	DATE	DESCRIPTION	BY	CHK	
DRAWING ISSUE STATUS					
NOT FOR CONSTRUCTION					
 HALEY WARD ENGINEERING ENVIRONMENTAL SURVEYING www.haleyward.com One Merchants Plaza, Suite 701 Bangor, Maine 04401 207.989.4824					
PROJECT					
MOUNTAIN ROAD PRIVATE WAY MOUNTAIN ROAD, RAYMOND MAINE					
TITLE					
OVERALL SITE PLAN					
DATE		2024.08.28		SCALE	1"=40'
DRAWN BY	DESIGNED BY	CHECKED BY			
PJM	PJM/DJO	JHW			
PROJECT No.					
14744.001					
DRAWING No.					
C101					

FILE LOCATION: P:\MET\124\RYAN_MORRELL\001\MOUNTAIN_ROAD_PRIVATE_WAY\HW22.CAD; FILEBATCH\14744.001.CAD; DWG, 2024.08.28, 10:27 AM

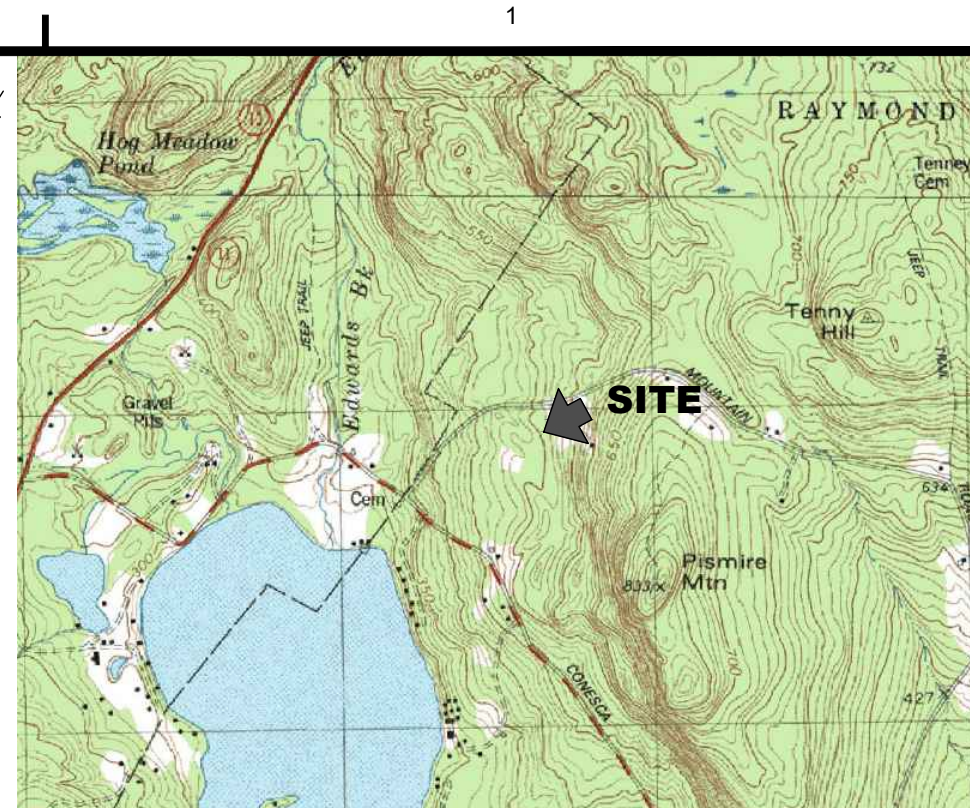
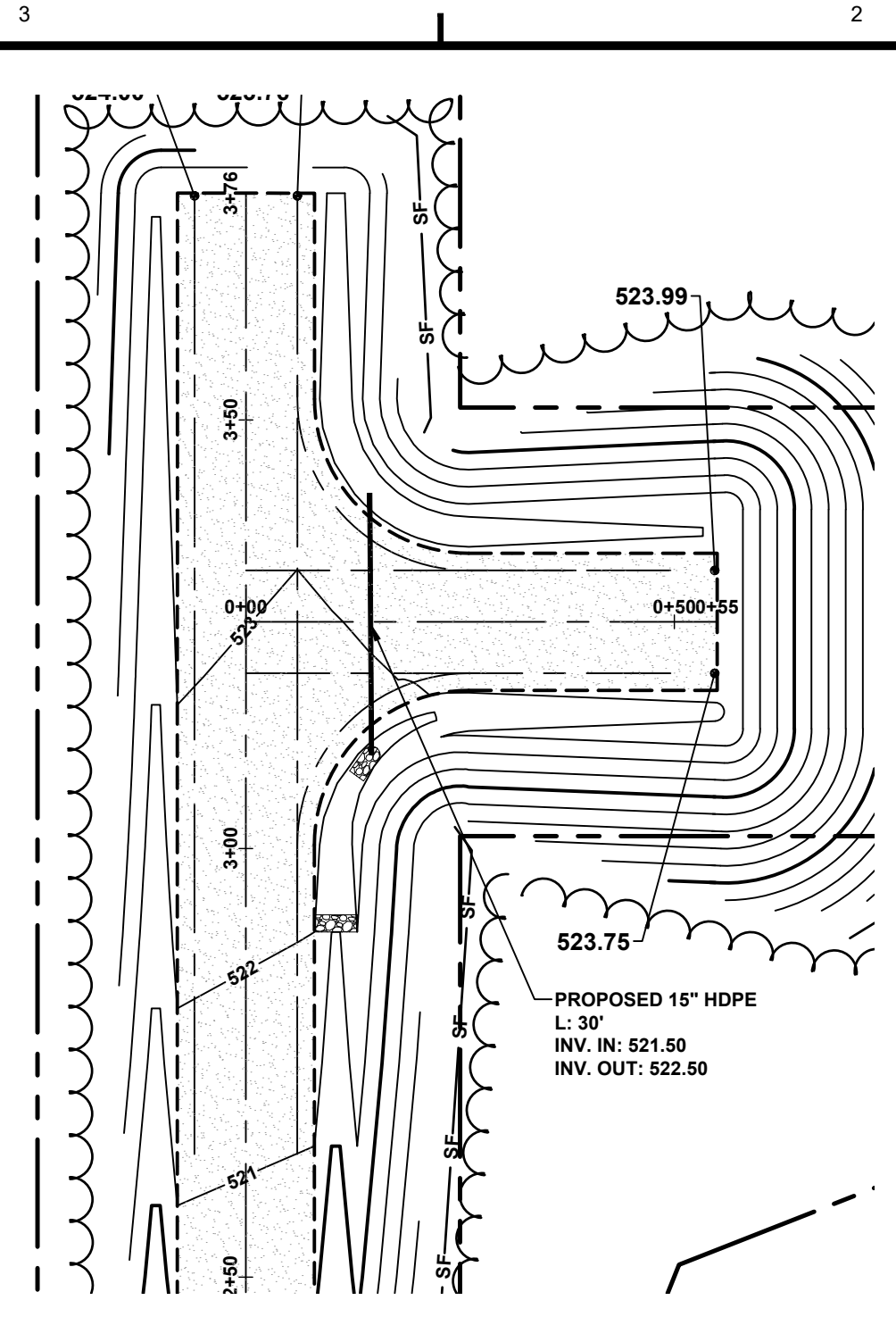
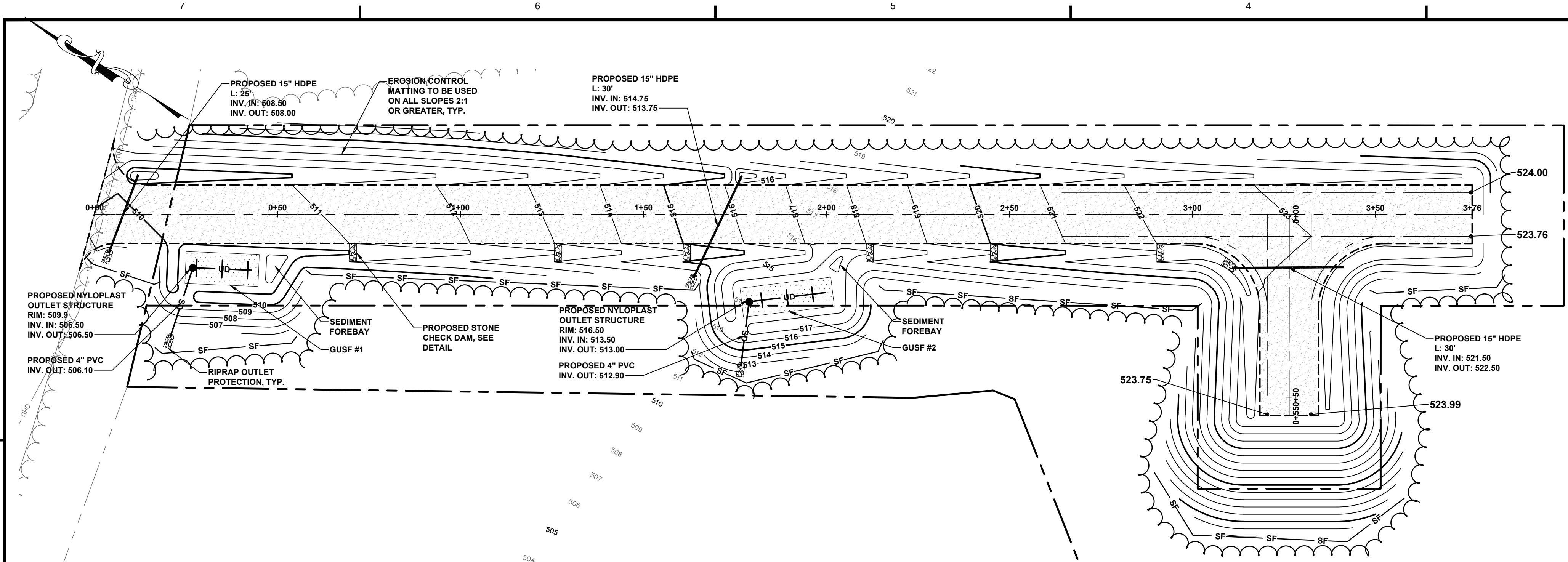

LOCATION MAP: USGS QUADRANGLE: RAYMOND
 MAPTECH® USGS TOPOGRAPHIC SERIES™
 ©MAPTECH®, INC. 978-933-3000
 WWW.MAPTECH.COM/TOPO
 SCALE: 1"=2000'

LEGEND:

DESCRIPTION	EXISTING	PROPOSED
PROPERTY LINE	---	---
BENCHMARK	⊕	⊕
SURVEY STATION	⊙	⊙
MANHOLE	⊕	⊕
UTILITY POLE	⊕	⊕
WELL	⊕	⊕
WATER VALVE	⊕	⊕
SIGN	⊕	⊕
CATCH BASIN	⊕	⊕
HYDRANT	⊕	⊕
EDGE OF GRAVEL	---	---
EDGE OF PAVEMENT	---	---
MAJOR FOOT CONTOUR	---	---
MINOR FOOT CONTOUR	---	---
STORM DRAIN	---	---
OVERHEAD UTILITIES	---	---
SILT FENCE	---	---
TREE LINE	---	---
GRAVEL SURFACE	---	---

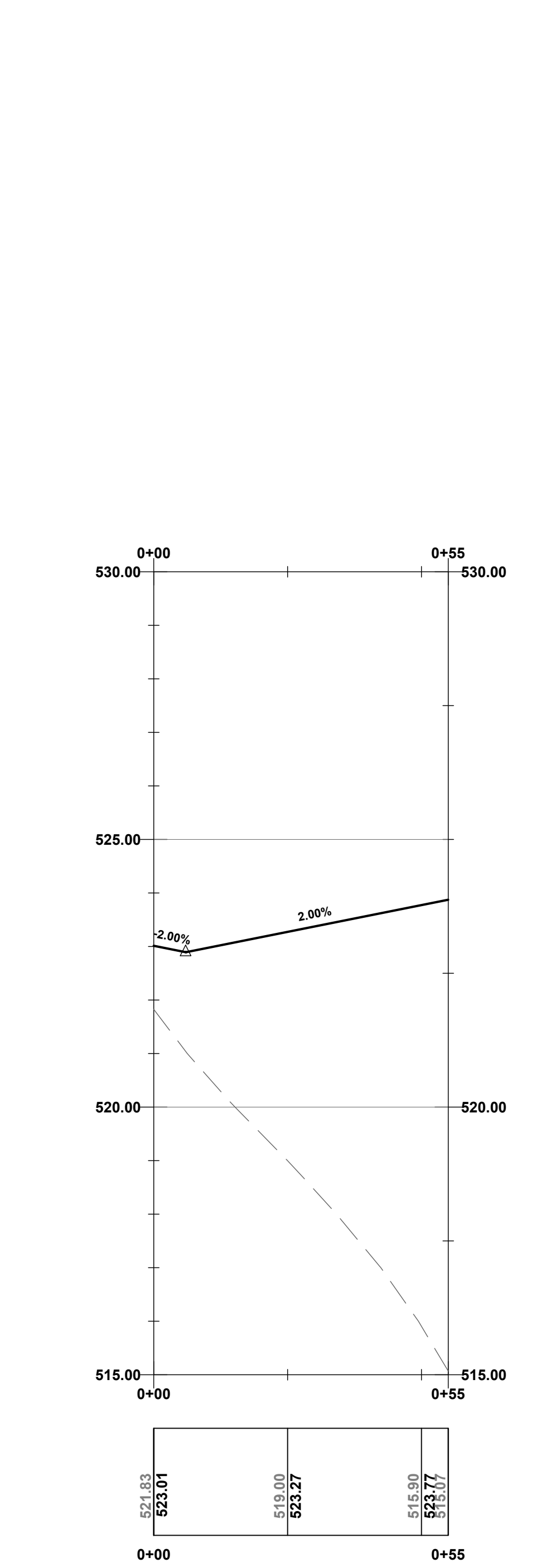
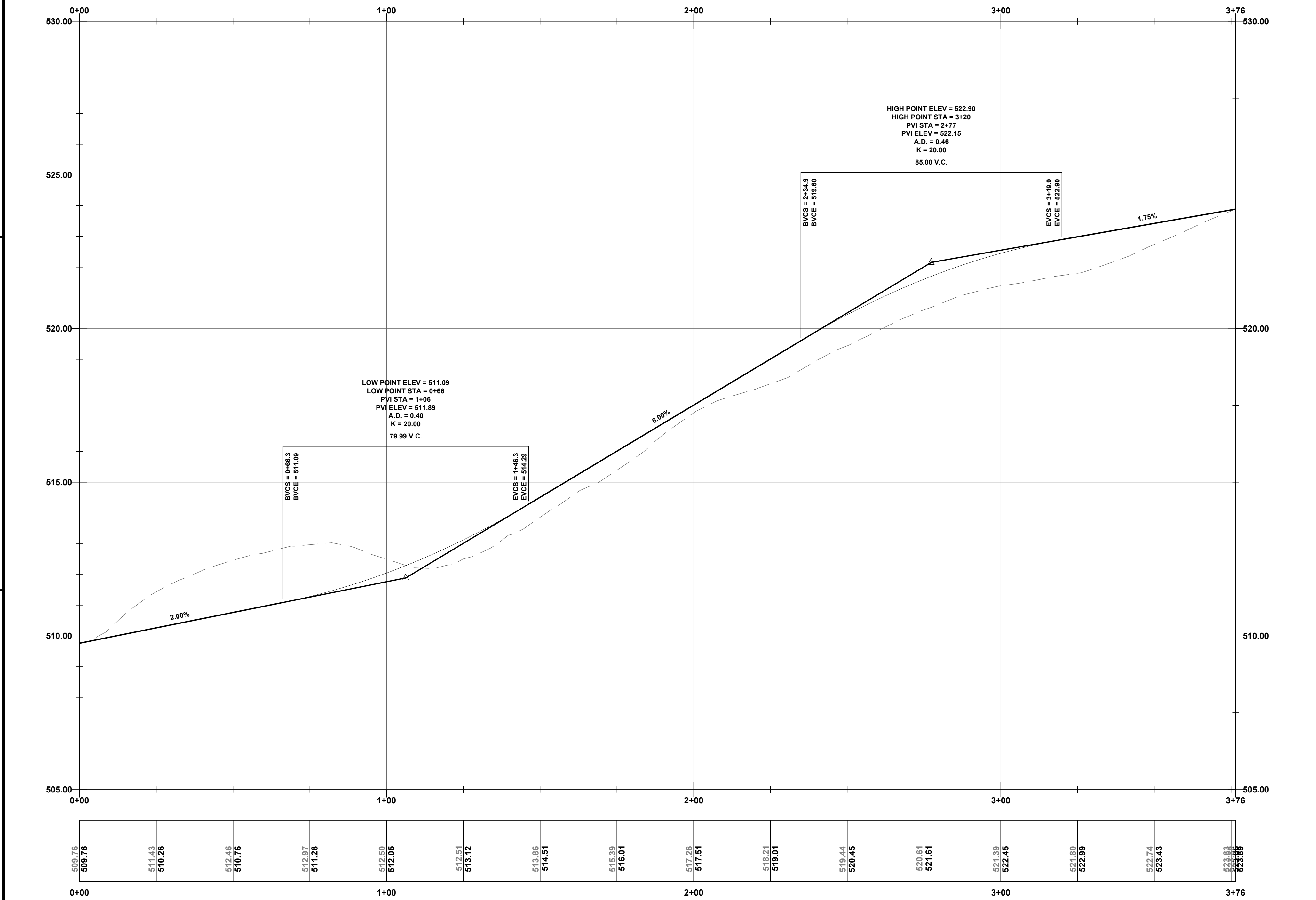

PLAN REFERENCE:

- AERIAL TOPOGRAPHY PROVIDED BY NOAA.
- PROPERTY LINES PROVIDED BY GPCOG ARCGIS MAPPING SERVICE.
- EXISTING CONDITIONS DRAFTED USING AERIAL IMAGERY PROVIDED BY MICROSOFT BING.

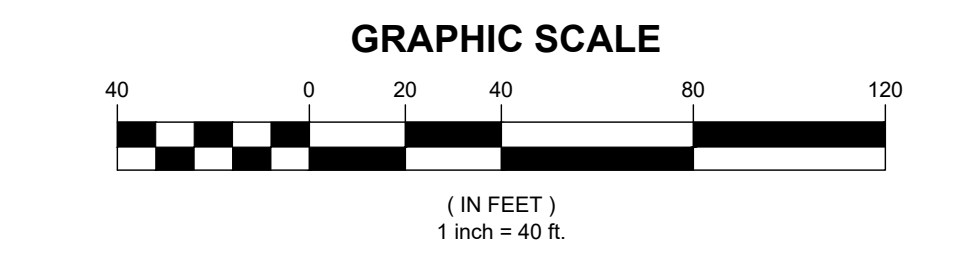

REV	DATE	DESCRIPTION	BY	CHK
DRAWING ISSUE STATUS				
NOT FOR CONSTRUCTION				
HALEY WARD ENGINEERING ENVIRONMENTAL SURVEYING WWW.HALEYWARD.COM One Merchants Plaza, Suite 701 Bangor, Maine 04401 207.989.4824				
PROJECT MOUNTAIN ROAD PRIVATE WAY MOUNTAIN ROAD, RAYMOND MAINE				
TITLE				
OVERALL SITE PLAN				
DATE: 2024.08.28		SCALE: 1"=40'		
DRAWN BY: PJM	DESIGNED BY: PJM/DJO	CHECKED BY: JHW		
PROJECT No. 14744.001				
DRAWING No. C102		REV.		

FILE LOCATION: P:\MOUNTAIN\RAYMOND\MOUNTAIN_PRIVATE_WAY\HW22-CAD\FILES\CAD\14744.001.C102.DWG, 2024.08.28, 10:28 AM

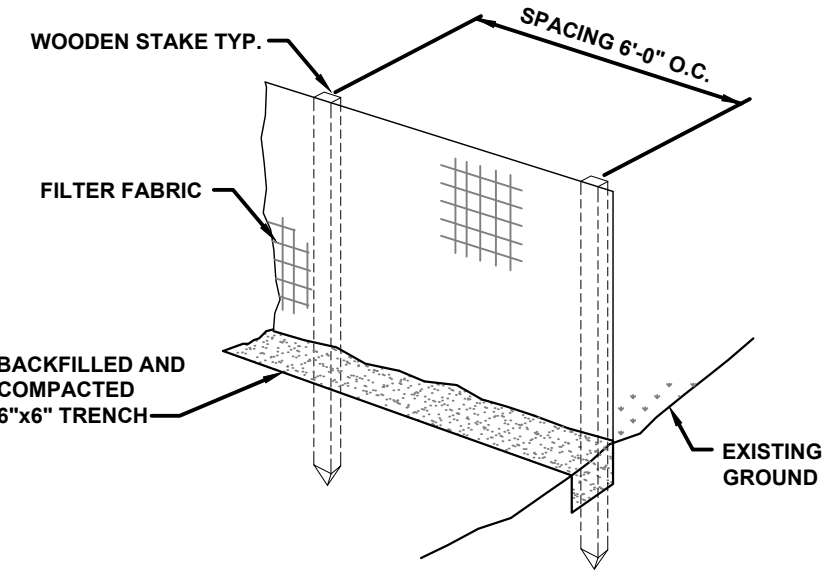

- NOTES:
1. KEY FABRIC IN A 6"x6" TRENCH W/BACKFILL AND COMPACT.
2. SILT FENCE SHALL BE A 3' FENCE WITH A MINIMUM GRAB STRENGTH OF 120 LBS.

SILT FENCE DETAIL

NTS

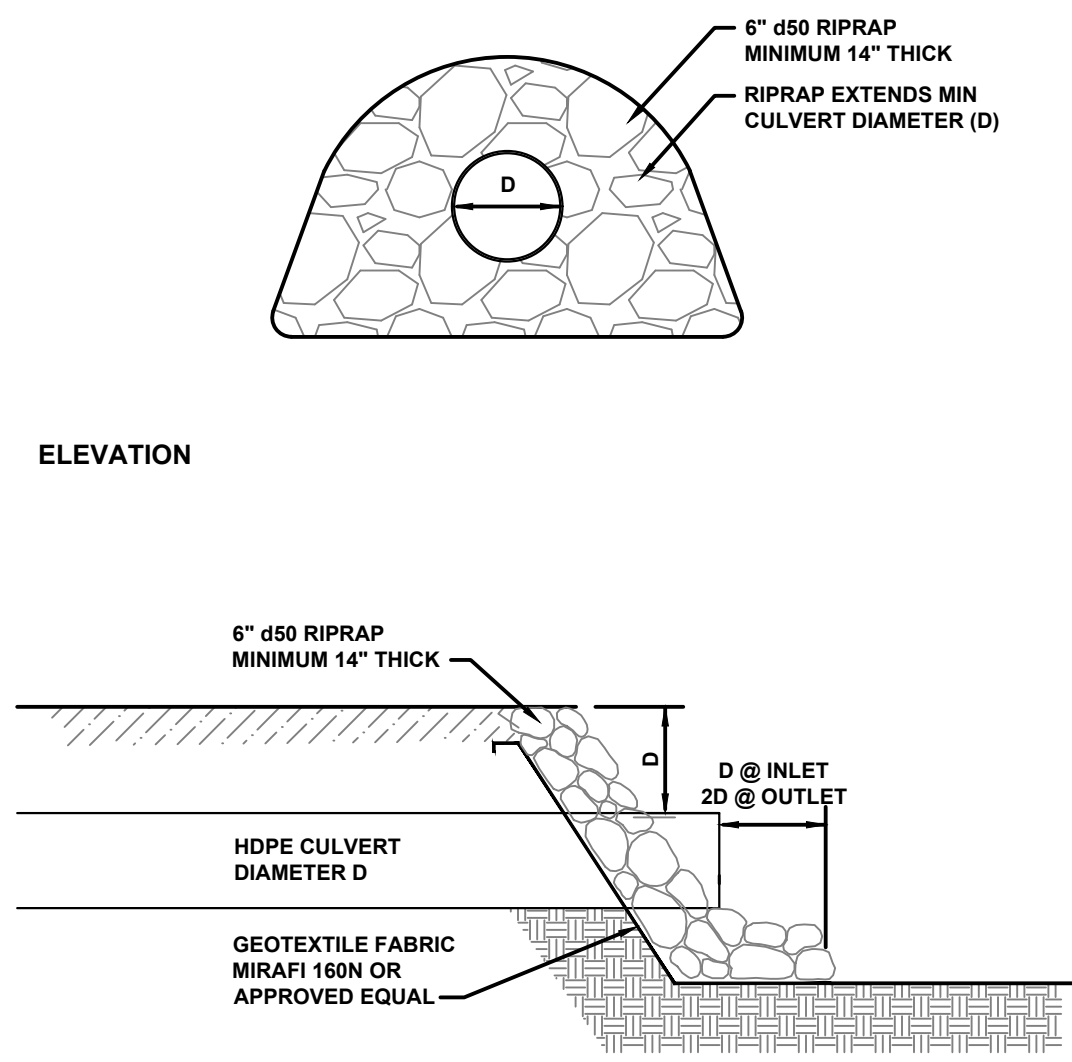

TYPICAL CULVERT INLET/OUTLET PROTECTION DETAIL

NTS

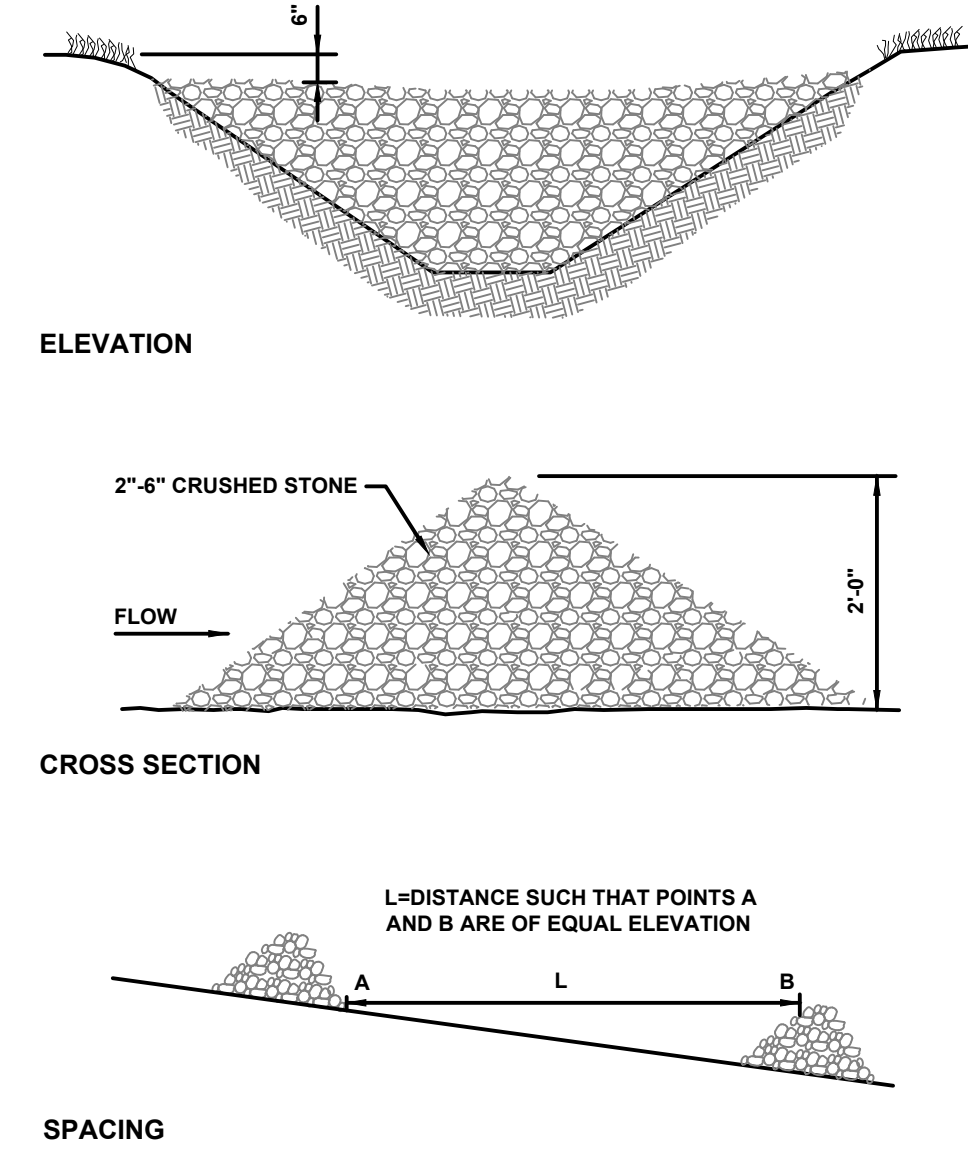

STONE CHECK DAM DETAIL

NTS

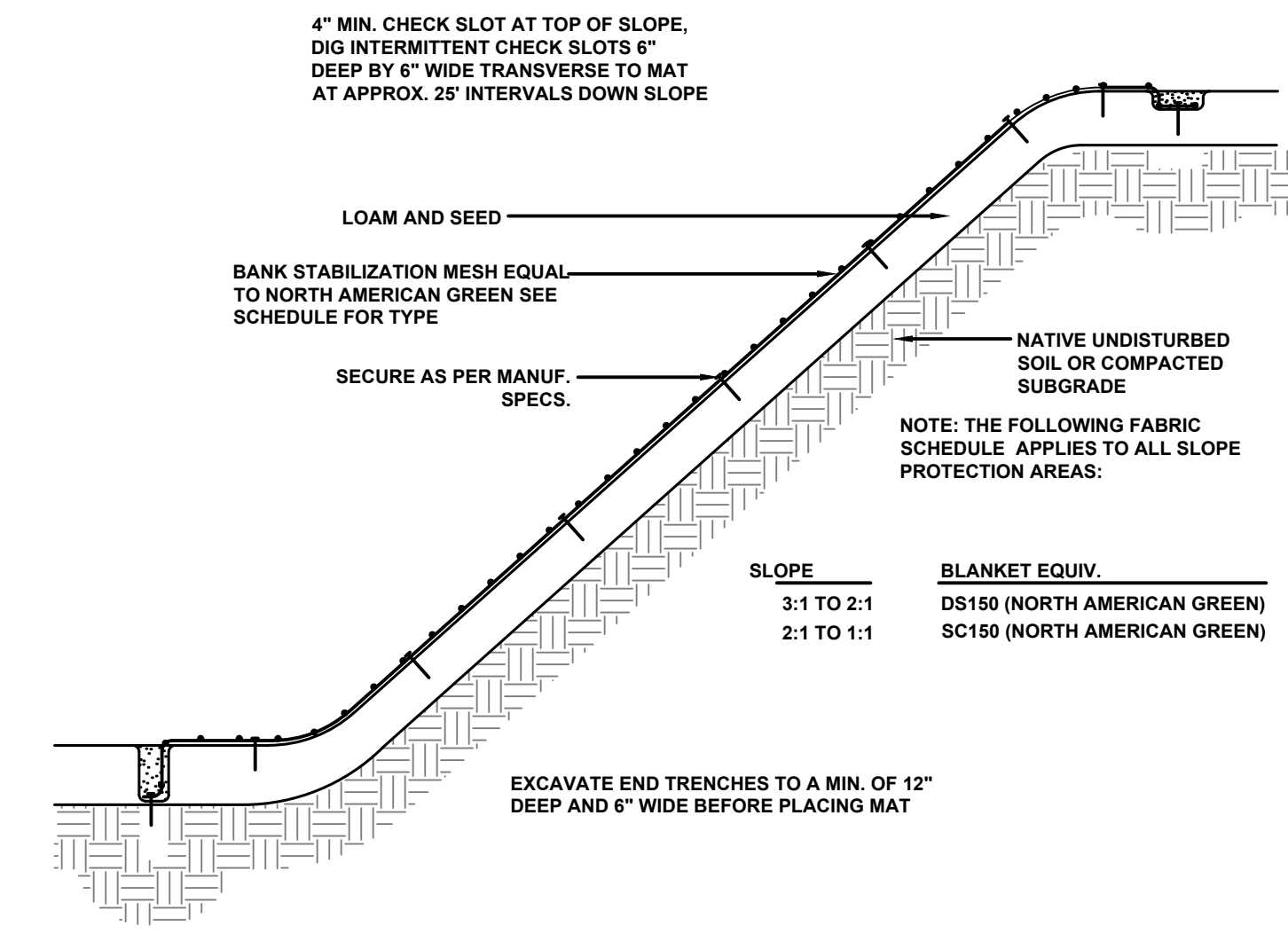

BANK STABILIZATION DETAIL

NTS

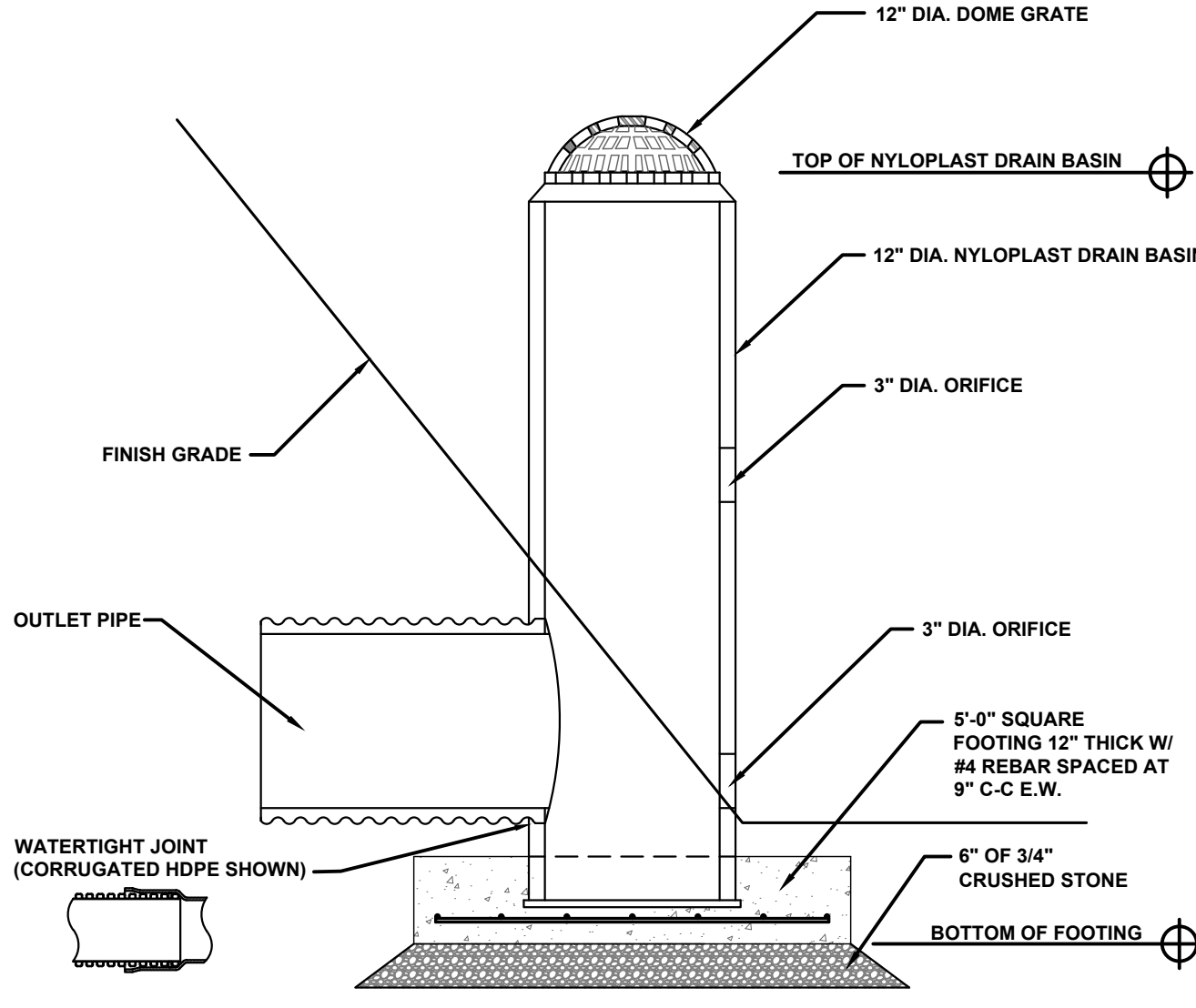

OUTLET STRUCTURE DETAIL

NTS

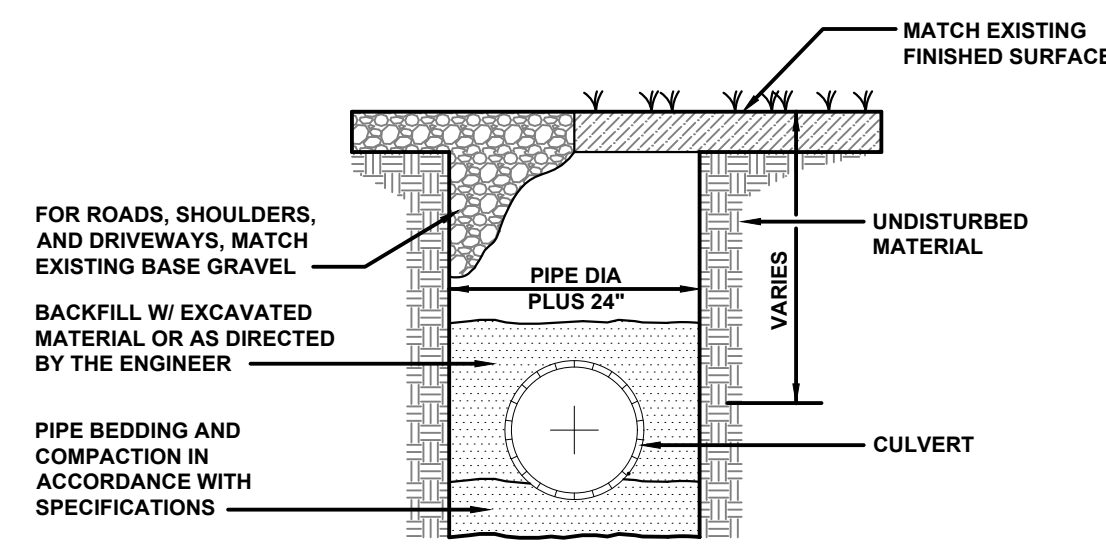

TYPICAL CULVERT TRENCH DETAIL

NTS

GUSF ID	EXISTING ELEVATION (+/-) (FT)	PROPOSED TOP OF FILTER (FT)	PROPOSED BOTTOM OF SOIL FILTER/TOP OF COARSE GRAVEL (FT)	PROPOSED ELEVATION OF PIPE BED (FT)	PROPOSED BOTTOM OF COARSE GRAVEL (FT)	PROPOSED OUTLET CONTROL STRUCTURE RIM (FT)	TREATMENT AREA REQ'D/PROVIDED (SF)
1	509.5	506.3	504.8	504.05	503.8	507.8	170/175
2	514.5	515.3	513.8	513.05	512.8	516.8	192/200

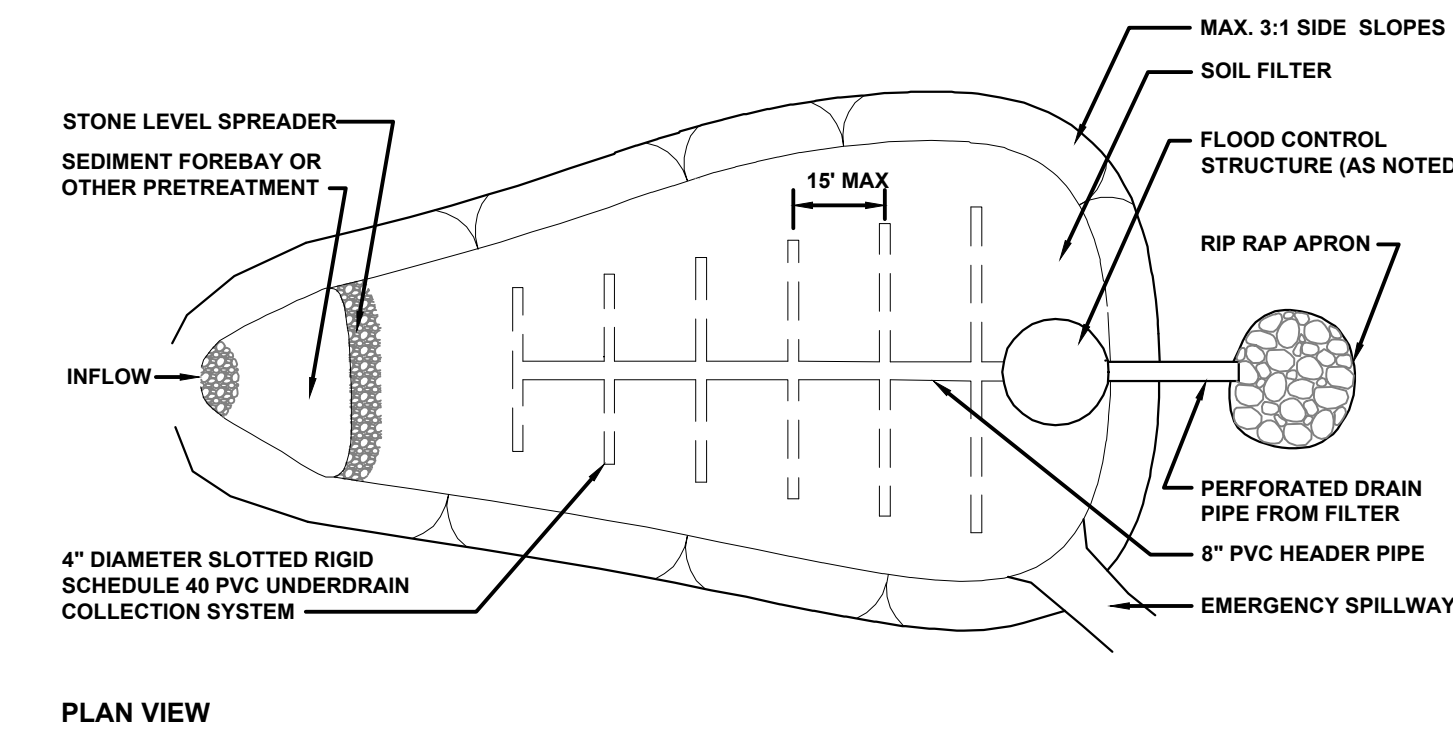

UNDERDRAIN SOIL FILTER DETAILS

N.T.S.

- NOTES:
1. GUSF (INCLUDING FOREBAYS) SHALL NOT BE USED FOR SNOW STORAGE.
2. VEHICLES ARE PROHIBITED FROM GUSF.
3. VEGETATION: THE SOIL FILTER SURFACE SHOULD BE PLANTED WITH A GRASS SPECIES THAT IS TOLERANT OF FREQUENT INUNDATION AND WELL DRAINED SOILS. UPON SEEDING, THE SOIL FILTER SHOULD BE MULCHED WITH HAY OR AN EROSION CONTROL MIXTURE. A CONSERVATION TYPE SEED MIXTURE IS APPROPRIATE (OR A 48 LBS/ACRE MIXTURE CONTAINING 20 LBS/ACRE OF CREEPING RED FESCUE AND TALL FESCUE EACH PLUS 9 LBS/ACRE OF BIRDSFOOT TREFOLI).

EROSION CONTROL NOTES

- ALL SEDIMENTATION AND EROSION CONTROL MEASURES SHALL BE IN ACCORDANCE WITH THE MAINE EROSION AND SEDIMENTATION CONTROL BMPs, PUBLISHED BY THE BUREAU OF LAND AND WATER QUALITY, MAINE DEPARTMENT OF ENVIRONMENTAL PROTECTION, LATEST EDITION.
- SILT FENCE WILL BE INSPECTED, REPLACED AND/OR REPAIRED IMMEDIATELY FOLLOWING ANY SIGNIFICANT RAINFALL OR SNOW MELT OR LOSS OF SERVICEABILITY DUE TO SEDIMENT ACCUMULATION. AT A MINIMUM, ALL EROSION CONTROL DEVICES WILL BE OBSERVED WEEKLY.
- DURING THE CONSTRUCTION PHASE, INTERCEPTED SEDIMENT WILL BE RETURNED TO CONSTRUCTION SITE.
- SEDIMENT CONTROL DEVICES SHALL REMAIN IN PLACE AND BE MAINTAINED BY THE CONTRACTOR UNTIL AREAS UPSLOPE ARE STABILIZED BY A SUITABLE GROWTH OF GRASS. ONCE A SUITABLE GROWTH OF GRASS HAS BEEN OBTAINED, ALL TEMPORARY EROSION CONTROL ITEMS SHALL BE REMOVED BY THE CONTRACTOR. ANY SEDIMENT DEPOSITS REMAINING IN PLACE AFTER THEY ARE REMOVED SHALL BE DRESSED TO CONFORM WITH THE EXISTING GRADE, PREPARED, SEEDED, AND MULCHED IMMEDIATELY.
- ALL DISTURBED AREAS WILL BE SEEDED WITH 2.5 LBS. RED FESCUE AND 0.5 LBS. RYE GRASS PER 1,000 SQUARE FEET AND MULCHED AT A RATE OF 90 LBS. PER 1,000 SQUARE FEET OR EQUIVALENT APPLICATION OF SEED AND MULCH.
- A SUITABLE BINDER SUCH AS CURASOL OR TERRTACK WILL BE USED ON THE HAY MULCH FOR WIND CONTROL.
- IF FINAL SEEDING OF DISTURBED AREAS IS NOT COMPLETED BY SEPTEMBER 15th OF THE YEAR OF CONSTRUCTION, THEN ON THAT DATE THESE AREAS WILL BE GRADED AND SEEDED WITH WINTER RYE AT THE RATE OF 112 POUNDS PER ACRE OR 3 POUNDS PER 1000 SQUARE FEET. THE RYE SEEDING WILL BE PRECEDED BY AN APPLICATION OF 3 TONS OF LIME AND 800 LBS. OF 10-20-20 FERTILIZER OR ITS EQUIVALENT. MULCH WILL BE APPLIED AT A RATE OF 90 POUNDS PER 1000 SQUARE FEET.
- IF THE RYE SEEDING CANNOT BE COMPLETED BY OCTOBER 1st OR IF THE RYE DOES NOT MAKE ADEQUATE GROWTH BY DECEMBER 1st, THEN ON THOSE DATES, HAY MULCH WILL BE APPLIED AT 150 POUNDS PER 1000 SQUARE FEET.
- ALL CATCH BASINS ARE TO BE PROTECTED BY STRAW BALE OR SILT FENCE IN ACCORDANCE WITH SECTION B-3 STORM DRAIN INLET PROTECTION OF THE MAINE BMP HANDBOOK. SURROUNDING AREAS CAN BE EXCAVATED OR LEFT LOW AS A SEDIMENT TRAP. CURB INLETS SHALL BE PROTECTED BY GUTTERATORS, OR APPROVED EQUIVALENT.
- INTERIOR SILT FENCES ALONG CONTOUR DIVIDING FLAT AND STEEP SLOPES, AREAS WITH DIFFERENT CIRCUMSTANCES SHOULD BE CONSIDERED BY THE CONTRACTOR. THE INTENT OF SUCH INTERIOR SILT FENCES IS TO LIMIT SEDIMENT TRANSPORT WITHIN THE SITE TOWARD THE PROTECTED CATCH BASIN INLETS TO MINIMIZE SEDIMENT REMOVAL REQUIRED BY THE EROSION CONTROL NOTE 9 PROTECTIONS AND EXTEND LIFE OF SUCH DEVICES.
- THE CONTRACTOR SHALL PROVIDE A SEDIMENT BASIN FOR ALL WATER PUMPED FROM EXCAVATIONS. BASIN SHALL BE DESIGNED AND CONSTRUCTED IN ACCORDANCE WITH THE "MAINE EROSION AND SEDIMENT HANDBOOK FOR CONSTRUCTION: BEST MANAGEMENT PRACTICES". THE CONTRACTOR SHALL SUBMIT FOR REVIEW/APPROVAL PRIOR TO BEGINNING ANY PROJECT WORK.
- DEWATERING
A DEWATERING PLAN IS NEEDED TO ADDRESS EXCAVATION DE-WATERING FOLLOWING HEAVY RAINFALL EVENTS OR WHERE THE EXCAVATION MAY INTERCEPT THE GROUNDWATER TABLE DURING CONSTRUCTION. THE COLLECTED WATER NEEDS TREATMENT AND A DISCHARGE POINT THAT WILL NOT CAUSE DOWNGRADIENT EROSION AND OFFSITE SEDIMENTATION OR WITHIN A RESOURCE. PLEASE FOLLOW THE DETAILS OF SUCH A PLAN.
- BASIC STANDARDS - EROSION CONTROL MEASURES:
MINIMUM EROSION CONTROL MEASURES WILL NEED TO BE IMPLEMENTED AND THE CONTRACTOR WILL BE RESPONSIBLE TO MAINTAIN ALL COMPONENTS OF THE EROSION CONTROL PLAN UNTIL THE SITE IS FULLY STABILIZED. HOWEVER, BASED ON SITE AND WEATHER CONDITIONS DURING CONSTRUCTION, ADDITIONAL EROSION CONTROL MEASURES MAY NEED TO BE IMPLEMENTED. ALL AREAS OF INSTABILITY AND EROSION MUST BE REPAIRED IMMEDIATELY DURING CONSTRUCTION AND NEED TO BE MAINTAINED UNTIL THE SITE IS FULLY STABILIZED OR VEGETATION IS ESTABLISHED. A CONSTRUCTION LOG MUST BE MAINTAINED FOR THE EROSION AND SEDIMENTATION CONTROL INSPECTIONS AND MAINTENANCE
CONTRACTOR WILL BE RESPONSIBLE FOR FOLLOWING PROCEDURES FOUND IN THE "MAINE EROSION AND SEDIMENT CONTROL PRACTICES FIELD GUIDE FOR CONTRACTORS" (PUBLISHED MARCH 2016). THE PUBLICATION CAN BE FOUND AT: [HTTP://WWW.MAINE.GOV/DEPLAND/EROSION/ESCBMPS/INDEX.HTML](http://www.maine.gov/dep/land/erosion/escbmps/index.html)
- PROPOSED EROSION CONTROL DEVICES ARE INTENDED TO BE THE MINIMUM LEVEL NECESSARY TO STABILIZE THE SITE AND PREVENT EROSION AND SEDIMENTATION. ADDITIONAL MEASURES MAY BE REQUIRED BASED ON THE FINDINGS OF THE SITE INSPECTIONS AND THE CHARACTERISTICS OF THE SITE.

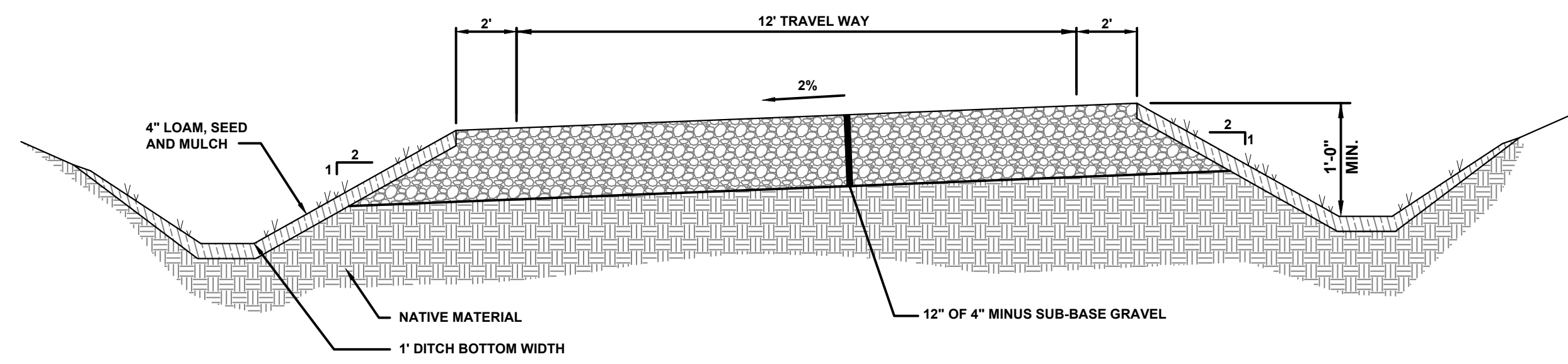

TYPICAL SUPERELEVATED ROADWAY CROSS SECTION

NTS

REV	DATE	DESCRIPTION	BY	CHK
DRAWING ISSUE STATUS				
NOT FOR CONSTRUCTION				
 HALEY WARD ENGINEERING ENVIRONMENTAL SURVEYING One Merchants Plaza, Suite 701 Bangor, Maine 04401 207.989.4824 WWW.HALEYWARD.COM				
PROJECT				
MOUNTAIN ROAD PRIVATE WAY MOUNTAIN ROAD, RAYMOND MAINE				
TITLE				
OVERALL SITE PLAN				
DATE 2024.08.28		SCALE NTS		
DRAWN BY PJM	DESIGNED BY PJM/DJO	CHECKED BY JHW		
PROJECT No. 14744.001				
DRAWING No. C501				

FILE LOCATION: P:\MET\124-RYAN_MORRELL\001-MOUNTAIN_PRIVATE_WAY\HW22-CAD_FILES\CAL\14744.001-CP-DWG_2024.08.28_10:28 AM



LEGEND:

AREA TREATED BY FILTER 1

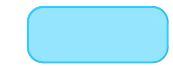

AREA TREATED BY FILTER 2

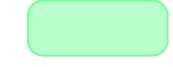

SOILS NOTE:

1. SOILS MAP DATA PROVIDED BY USDA NATURAL RESOURCES CONSERVATION SERVICE.

GRAPHIC SCALE

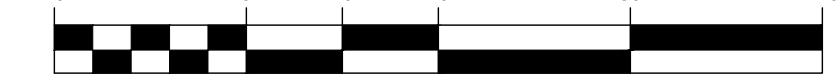

(IN FEET)
1 inch = 40 ft.

REV	DATE	DESCRIPTION	BY	CHK
DRAWING ISSUE STATUS				

NOT FOR CONSTRUCTION

PROJECT
MOUNTAIN ROAD PRIVATE WAY
 MOUNTAIN ROAD, RAYMOND MAINE

TITLE
STORMWATER TREATMENT PLAN

DATE	SCALE
2024.08.28	1"=40'
DRAWN BY PJM	DESIGNED BY PJM/DJO
CHECKED BY JHW	
PROJECT No. 14744.001	
DRAWING No. C703	

FILE LOCATION: P:\MET\124\RYAN_MORRELL\00\MOUNTAIN_ROAD_PRIVATE_WAY\HW02.CAD / FILED:\CAL\124\01\124\HW02.DWG, 2024.08.28, 10:28 AM



N/E
CARL H
RICHARDSON
BOOK 7681 - PAGE 93
MAP 15 - LOT 82