

LOCATION MAP N.T.S.

ROBERT A. MCSOLEY, P.E. NO. 6696

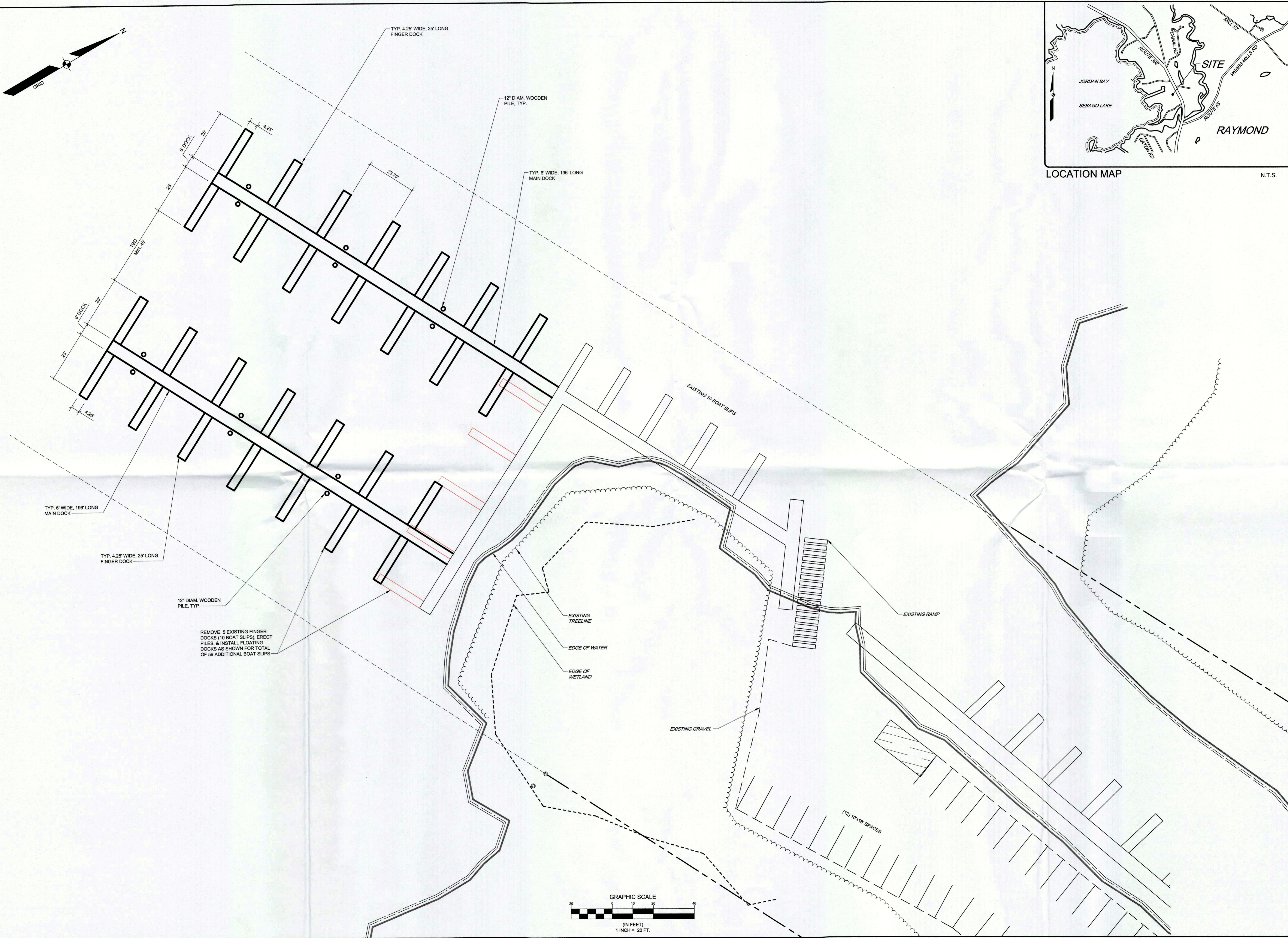

REMOVE 5 EXISTING FINGER DOCKS (10 BOAT SLIPS), ERECT PILES, & INSTALL FLOATING DOCKS AS SHOWN FOR TOTAL OF 59 ADDITIONAL BOAT SLIPS

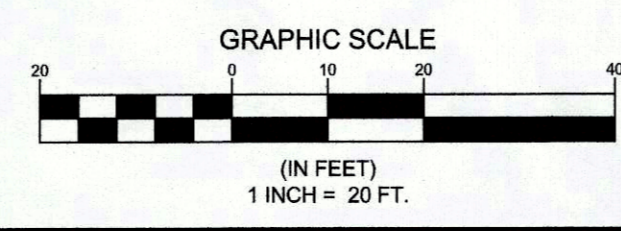

REV.	BY	DATE	STATUS
A	RAM	12/20/19	DEP SUBMISSION

THIS PLAN SHALL NOT BE MODIFIED WITHOUT WRITTEN PERMISSION FROM SEBAGO TECHNICS, INC. ANY ALTERATIONS, AUTHORIZED OR OTHERWISE, SHALL BE AT THE USER'S SOLE RISK AND WITHOUT LIABILITY TO SEBAGO TECHNICS, INC.

SEBAGO
TECHNICS

75 John Roberts Rd.
Suite 4A
South Portland, ME 04106
Tel: 207-260-2100

WWW.SEBAGOTECHNICS.COM

SITE PLAN
OF:
JORDAN BAY MARINA
1328 ROOSEVELT TRAIL
RAYMOND, ME 04071

FOR:
PORT HARBOR HOLDINGS I
ONE SPRING POINT DRIVE
SOUTH PORTLAND, ME 04106

DESIGNED	RAM
DRAWN	KJR
CHECKED	RAM
DATE	12/20/19
SCALE	1" = 20'
PROJECT	14265