

THIS MAP IS PREPARED FOR THE INVENTORY OF REAL PROPERTY AND THE TOWN OF RAYMOND AND IS COMPILED FROM RECORDED DEEDS, PLATS, TAX MAPS, SURVEYS, PLANIMETRIC MAPS AND OTHER PUBLIC RECORDS AND DATA. USERS OF THIS TAX MAP ARE HEREBY NOTIFIED THAT THE FOREMENTIONED PUBLIC PRIMARY

INFORMATION SOURCES SHOULD BE CONSULTED FOR VERIFICATION OF THE INFORMATION CONTAINED ON THIS MAP. THE TOWN OF RAYMOND AND ITS MAPPING CONTRACTORS ASSUME NO LEGAL RESPONSIBILITY FOR THE INFORMATION CONTAINED HEREIN.

**TOWN OF RAYMOND**  
**Cumberland County, Maine**  
**2022 Property Map**

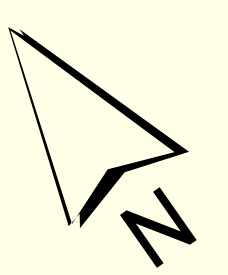

Sources:  
 Raymond Assessors Database  
 Maine Office of GIS  
 Prepared by:  
 Sebago Technics, Inc.  
 Effective Date: April 1, 2022



**Map 01**

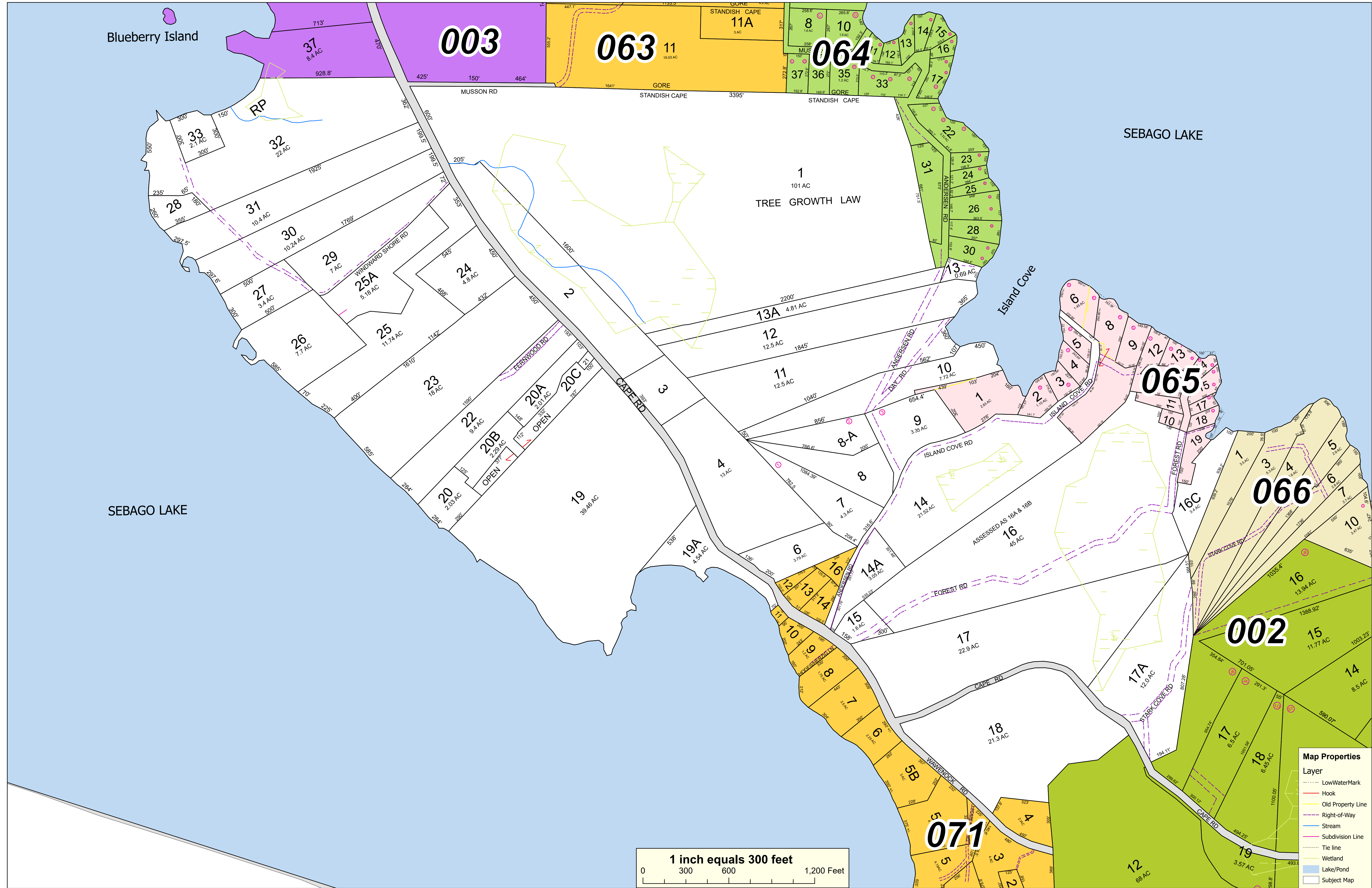

**Map Properties**

Layer	Symbol
LowWaterMark	Blue dashed line
Hook	Red dashed line
Old Property Line	Yellow dashed line
Right-of-Way	Purple dashed line
Stream	Blue solid line
Subdivision Line	Pink solid line
Tie line	Black dotted line
Wetland	Green solid area
Lake/Pond	Light blue solid area
Subject Map	White solid area

