

THIS MAP IS PREPARED FOR THE INVENTORY OF REAL PROPERTY AND THE TOWN OF RAYMOND AND IS COMPILED FROM RECORDED DEEDS, PLATS, TAX MAPS, SURVEYS, PLANIMETRIC MAPS AND OTHER PUBLIC RECORDS AND DATA. USERS OF THIS TAX MAP ARE HEREBY NOTIFIED THAT THE AFOREMENTIONED PUBLIC PRIMARY INFORMATION SOURCES SHOULD BE CONSULTED FOR VERIFICATION OF THE INFORMATION CONTAINED ON THIS MAP. THE TOWN OF RAYMOND AND ITS MAPPING CONTRACTORS ASSUME NO LEGAL RESPONSIBILITY FOR THE INFORMATION CONTAINED HEREIN.

**TOWN OF RAYMOND**  
**Cumberland County, Maine**  
**2022 Property Map**

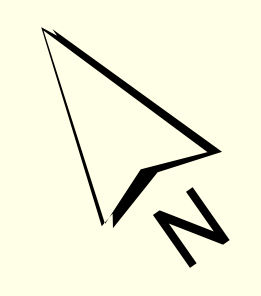

Sources:  
 Raymond Assessors' Database  
 Maine Office of GIS  
 Prepared by:  
 Sabago Technics, Inc.  
 Effective Date: April 1, 2022



**Map 09**

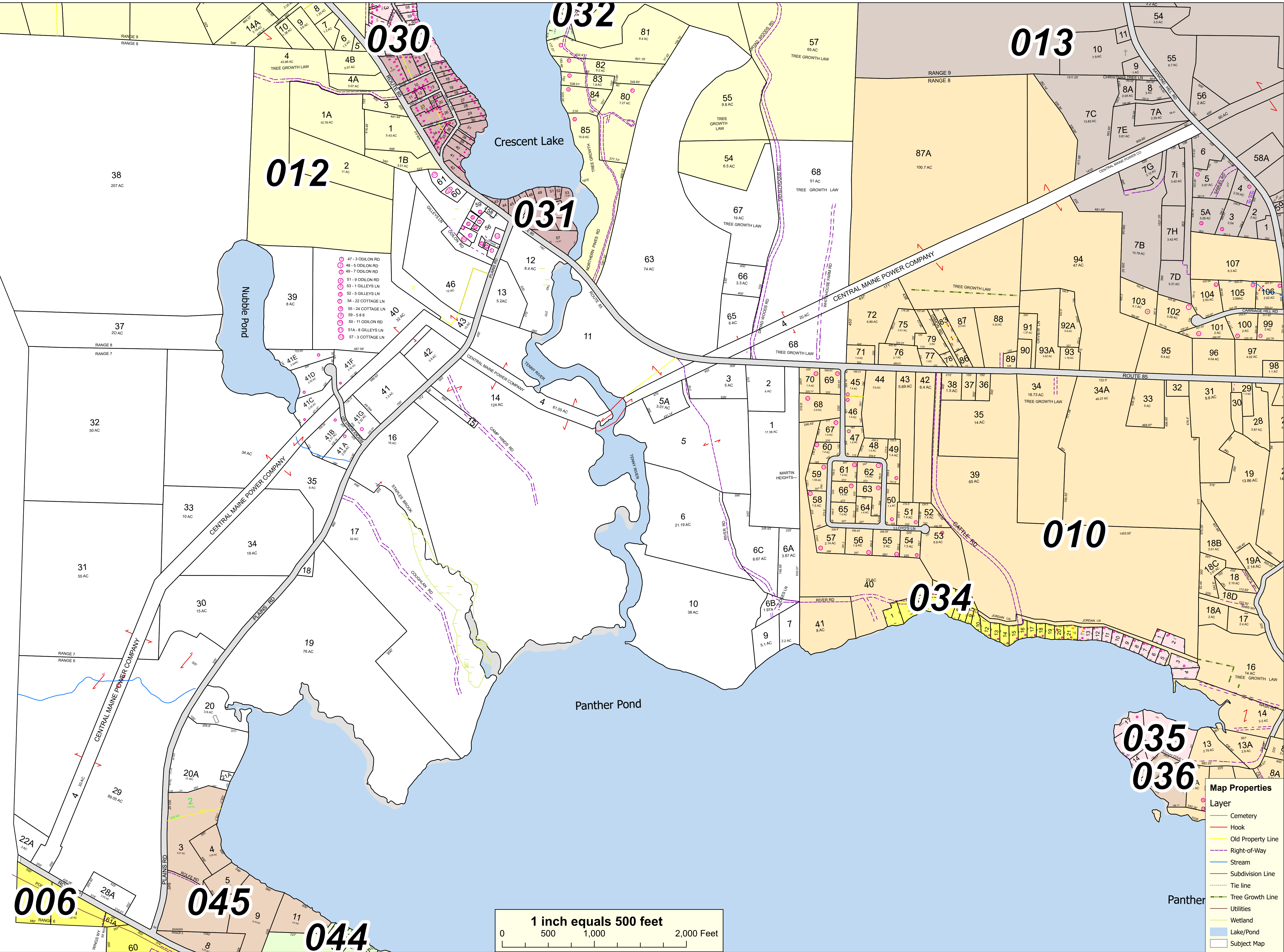

- 47 - 3 OODLON RD
- 48 - 5 OODLON RD
- 49 - 7 OODLON RD
- 51 - 9 OODLON RD
- 53 - 1 GILLEY'S LN
- 52 - 5 GILLEY'S LN
- 55 - 24 COTTAGE LN
- 56 - 5 B'S
- 50 - 11 OODLON RD
- 51A - 8 GILLEY'S LN
- 57 - 3 COTTAGE LN

CASCO

