

THIS MAP IS PREPARED FOR THE INVENTORY OF REAL PROPERTY IN THE TOWN OF RAYMOND AND IS COMPILED FROM RECORDED DEEDS, PLATS, TAX MAPS, SURVEYS, PLANIMETRIC MAPS AND OTHER PUBLIC RECORDS AND DATA. USERS OF THIS TAX MAP ARE HEREBY NOTIFIED THAT THE AFOREMENTIONED PUBLIC PRIMARY INFORMATION SOURCES SHOULD BE CONSULTED FOR VERIFICATION OF THE INFORMATION CONTAINED ON THIS MAP. THE TOWN OF RAYMOND AND ITS MAPPING CONTRACTORS ASSUME NO LEGAL RESPONSIBILITY FOR THE INFORMATION CONTAINED HEREIN.

**TOWN OF RAYMOND**  
**Cumberland County, Maine**  
**2022 Property Map**

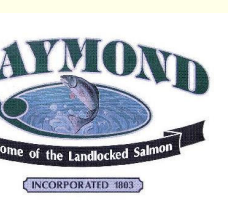

Sources:  
 Raymond Assessors' Database  
 Maine Office of GIS  
 Prepared by:  
 Sebago Technics, Inc.  
 Effective Date: April 1, 2022



**Map 46**

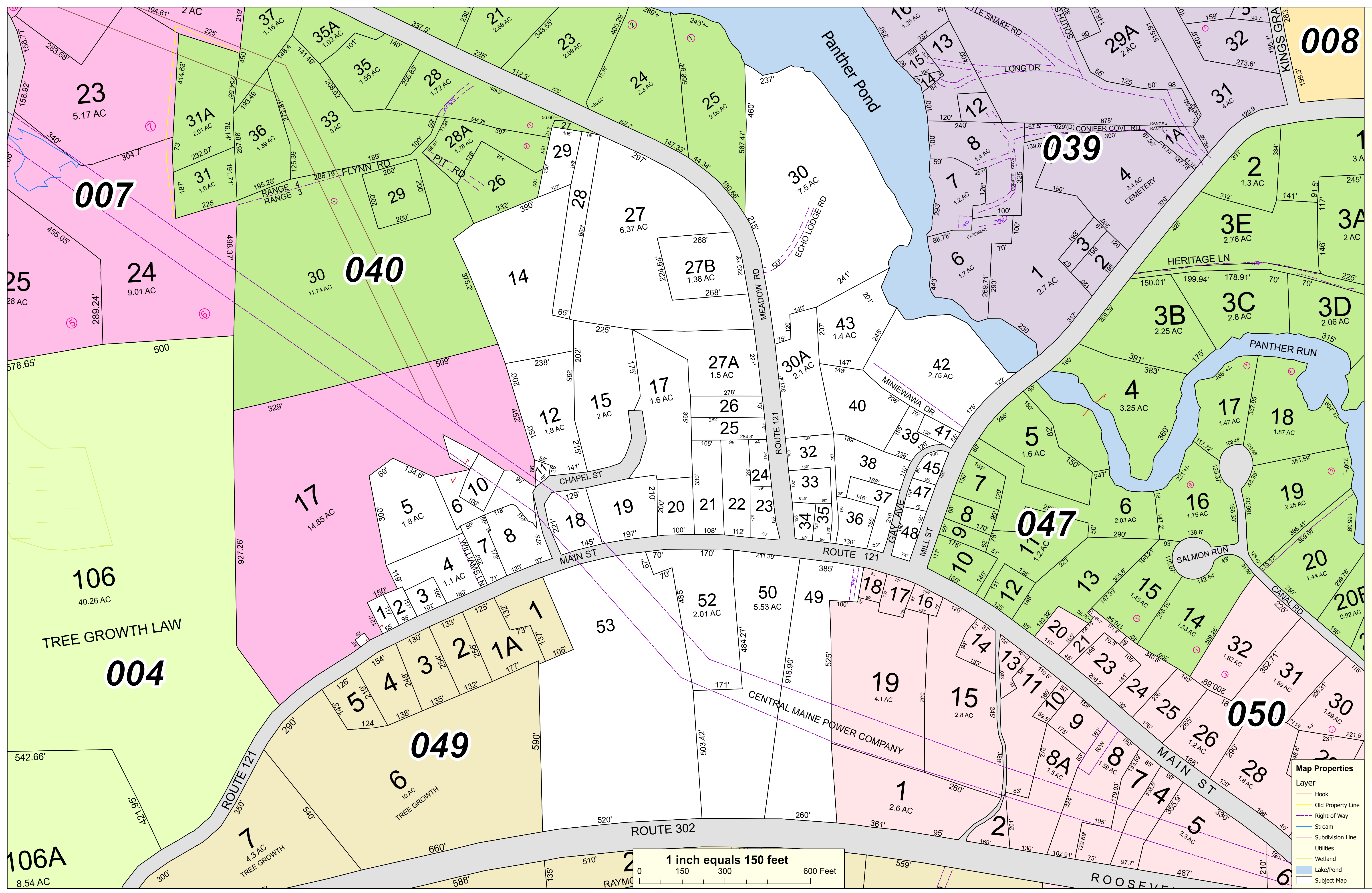

**Map Properties**

Layer	Color
Hook	Red
Old Property Line	Yellow
Right-of-Way	Purple
Stream	Blue
Subdivision Line	Pink
Utilities	Orange
Wetland	Light Green
Lake/Pond	Light Blue
Subject Map	White